

P16 SELECT





Select from our extensive offer...

Art & Design
Biology
Chemistry
Computer Science
Design & Technology
Drama
English Literature
English Language & Literature
Geography
History
Law
Mathematics
Further Mathematics
Media Studies

Photography
Politics
Psychology
Physics
R.E - Philosophy & Ethics
Sociology
Spanish

RSL Music
BTEC Sport
BTEC I.T
BTEC Business
BTEC Health & Social Care

Post 16 Select





P16 WELCOME

Welcome to Post 16 Select at President Kennedy School.

At President Kennedy School, everything we do is focused on Building Brighter Futures for all of our students and our wider community.

A crucial part of Building Brighter Futures, for our students, is providing a high-quality educational experience delivered through an academic curriculum and an exceptional programme of enriching experiences.

Our aim is for all students to leave Post 16 as exceptional young people with the qualifications,

personal qualities, and knowledge to be fully prepared for **LIFE, ACADEMIA, and WORK** for the next stage of their lives.

Our Post 16 academic enrichment programme offers students a wide range of opportunities, challenges, and experiences inside and outside of the classroom. We all aspire to the highest standards in everything we do, and this is demonstrated in the purposes and successes of our students. Our Post 16 community is built around demonstrating PRIDE in everything we do.

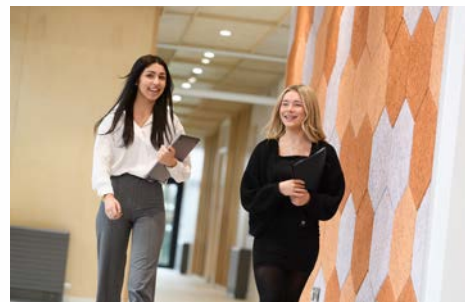

Be fully prepared...



LIFE



ACADEMIA



WORK



P16 STATE OF THE ART BUILDING

President Kennedy School's Post 16 enjoys the benefit of being in its own separate building, adjacent to the main school.

In this building, which opened in October 2021, we have state of the art facilities including a number of Post 16 classrooms, three science laboratories, and a computer room.

Students have spacious study areas and their own canteen facilities.

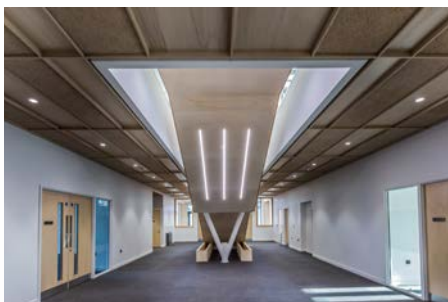



POST 16 | MEET THE TEAM



Eleanor Mitchard

**Assistant Headteacher
College Director of Post 16**



Rebecca Wilkinson

**Futures Leader and Post 18
Progression**

Supports the students through
the UCAS process



Sophie Rejali

**Leader of P16 Student
Experience**

Coordinates our student
leadership programme and
enrichment opportunities



Selina Sanger

**Post 16 Comms Officer &
Pastoral Support**

First point of contact for parents
and manages the administration
of the P16 college



Sam Bartley

Post 16 Pastoral Manager

Supports the health and
wellbeing of Post 16 students



Eleanor Soutter Pettitt

Leader of P16 Pathways

Supports students with their
applications to university
pathway schemes



Chantelle Worwood

Careers Leader

Supports students with Post 16
Options



Andy Fogarty

Assistant Headteacher

Careers and Vocational studies
Director





P16 PLEDGE

President Kennedy School's Post 16 pledges to give every student the opportunity to:

- Take part in a work related experience
- Represent and promote the school at an event
- Regularly take part in an extra-curricular activity
- Contribute to our school community by volunteering as a subject ambassador or learning mentor
- Contribute to our wider community by volunteering, supporting a charity, or getting involved in a project
- Take part in a University Outreach Programme or visit a university
- Participate in our financial education course delivered through our tutor curriculum
- Have a 1-to-1 meeting with our school careers advisor
- Develop key skills such as CV writing and interview preparation to support employability





P RIDE

Students follow the Post 16 professional dress code and support this ethos in the school.

Students are role models within the school, in the community, and in society. Students are prepared for Life, Academia, and Work and can communicate in a sophisticated and articulate manner in the wider world.

R ESPECT

Students show respect in their learning and follow British values.

Post 16 students have professional conversations with their teachers, peers, and other members of the community. Students celebrate the diversity and cultures within Post 16.

I NVOLVEMENT

All students participate in, and value leadership opportunities every week.

Post 16 students have an impact on their P16, the school, their local community, and beyond their local community.

All students engage with the Super Curriculum in their subject. Students engage with numerous/university pathways.

D ETERMINATION

All students take responsibility for their own learning and support others' learning.

All students work effectively in study periods and use this time to better themselves academically and professionally.

Students are aspirational in their choices Post 18 and push themselves beyond their own comfort zone.

E XCELLENCE

All students work to the best of their ability to give themselves as many choices as possible.

Post 16 students are prepared for their learning and support others with their learning.

Post 16 students are reflective learners and take on board feedback to improve themselves academically, professionally, and personally.

Students develop leadership skills which prepare them for Life, Academia, and Work so that they thrive in the wider world and become a positive voice for social change.



P16

FUTURE

LEADERS

AWARD



FUTURE LEADERS AWARD

President Kennedy's Post-16 personal development programme is delivered through the Future Leaders Award.

All Year 12 students will receive an award at the end of the year for having made achievements in each of the following areas:

- **Student Leadership**
- **Extra-curricular enrichment**
- **Super-curricular engagement**
- **Work experience**

Over the course Y12 students complete a portfolio of evidence that they have engaged with all of these areas. Students submit in their portfolio in the Summer term and then in final PRIDE assembly they presented with a 'Future Leaders Award' that demonstrates their phenomenal achievements and impact on the President Kennedy Community and next steps towards Post-18. This programme helps students to capture all the ways they have thrived in Post-16 and can support their applications to University, Apprenticeships and the workplace.

The final award given to students at the end of the year will either be bronze, silver, or gold level based on how they have engaged with the programme.

STUDENT LEADERSHIP

All Year 12 students are required to do one-hour a week (minimum) of student leadership. This leadership can be completed in a number of roles including: Head students, subject ambassadors, diversity ambassadors, charity committee, events team, journalism club, 1-2-1 reading and peer mentoring. Our Year 12 students give back to the school community and at the same time learn a number of important leadership skills including communication and confidence, that help support them with their future ambitions.

EXTRA-CURRICULAR ENRICHMENT

At President Kennedy we encourage our students to have a healthy work-life balance. This means that while completing their studies here, students are encouraged to join an extra-curricular club they

are passionate about. Current clubs and societies on offer include: moral questions club, debate club, reading club, Youth Speaks and sports sessions. We actively encourage students to create their own societies and groups that they enjoy. Current students are in the midst of developing a medical society and wellbeing club.

SUPER-CURRICULAR ENGAGEMENT

Students are expected to take their learning beyond the curriculum that is taught in lessons. This part of the Future Leaders Award gives students capacity to engage with and reflect on the super-curriculum. They delve into their subjects further outside what is taught within the classroom. For example, students are given the opportunity to read books, specialist magazines and journals. They are given links to podcasts and documentaries. Throughout the course of the year students are encouraged to take part in online courses and enter academic competitions. There are also a number of trips run by the school to immerse students in the wider world.

Last year students went on a number of trips including to Cambridge University and Poland to expand their super-curricular experiences.

A significant part of the super-curricular offer students receive is the opportunity to engage with an academic journal. Students will write a submission on each term's big question in an academic style with professional referencing. Our current question for this term is: What has been the greatest invention of all time? Students are invited to answer this from any subject discipline they are interested in. Each essay is checked by the editorial team who will then compile them into a journal edition, which will be available for all staff and students to read.

WORK-EXPERIENCE

The final component of the Future Leaders Award is completing a work-experience placement. All Year 12 students will have the opportunity to complete work experience that will help support their future ambitions. All Post-16 students have access to a careers advisor who can help support them with these placements. This gives the opportunity for students to familiarise themselves with the professional application process, the workplace environment and reflect on the skills they have learnt.

ETHICS CONFERENCE

In July, President Kennedy hosts its annual Ethics Conference. The Conference provides Post-16 students with the opportunity to attend lectures and seminars with professional from many different fields. Our last Conference was held on 17th July 2024. All Year 12 students from President Kennedy, Stoke Park and Barr's Hill Schools attended the day. They began their day listening to the first keynote speaker, Dan Belcher. Dan is an education specialist and leads on the SSAT's leadership programmes. He delivered a fascinating talk on the impact of ethics in education and asked students in the audience thought-provoking questions to get them to consider their own values. Students then attended two workshops of their own choice based around their future career aspirations.

There were workshops held on theology and the Holocaust; social care; sustainability; medicine; law; politics; violence prevention; philosophy; education; policing; charity; AI; marketing and finance. All workshops explored the role Ethics plays within these fields. Speakers ranged from President Kennedy alumni, Jas Bhambra, to local councillor Esther Reeves. In total 19 professional speakers delivered talks across the course of the day. Students ended the day by listening an incredibly moving keynote speech from Holocaust survivor, Peter Lantos. Peter spoke about his experiences in concentration camp Bergen-Belsen and held a question and answer session. This event gives our Post-16 students an opportunity to attend a conference with workplace professionals and inspires them in their future aspirations.

ROTARY CLUB

President Kennedy work closely with the Rotary Club to provide opportunities for students. Every year, three Year 12 form a debating team to enter the Youth Speaks competition. This year, the President Kennedy Team won their first three district debates and went on the place overall 2nd at the National Competition. This prestigious event gives students the opportunity to speak in front of large audiences and grow in confidence. Another event our students are involved in annually is the Santa's Sleigh charity collection around Holbrooks.





Art & Design: Photography or Fine Art Specialisms

The Art department forms part of the Create & Perform Faculty at Barr's Hill School. We are committed to ensuring students receive top quality teaching and learning experiences. Students will be taught by passionate and experienced staff in our specialist rooms including 2 Art rooms, a photography studio and a photography dark room.

Alongside the course there will be opportunities to take part in contemporary studies to support them with their future aspirations.

Entry Requirements

- We require 5 GCSEs at grade 5 or above.

Many students taking A-level Art have a GCSE in Art or Photography and enjoy the combination of practical, technical, creative, and contextual demands involved in such a practical, coursework-laden subject. Students without an Art GCSE should have some equivalent experience that reflects their creative and practical interests for example they should have evidence of developing skills, ideas and understanding relating to a specific theme in art and/or photography.

Topics covered

During this course you will have the opportunity to develop expertise in observation, critical analysis and experimentation. You will refine your art and design skills in your chosen specialism, taking advantage of the facilities we are able to offer. Support and guidance will be provided throughout the course and historically the average grade that student achieve on this course is grade A.

Skills you will develop on the course

All A-level Art courses introduce you to a wide range of media and processes. These will always include drawing, whatever specialism you choose, but can also include a range of other techniques and processes: painting, printmaking, collage, photography, digital work, mixed media, sculpture, film and performance. The area you spend most time on will depend on the direction and focus of your chosen specialism. You will develop an extensive range of creative practical work, with some supporting 'contextual skills'.

Assessment

We follow the AQA Art & Design specification. The 2-year course has 2 units:

- 1.) 50% portfolio consisting of a personal investigation of your own chosen theme,
- 2.) 50% externally set assignment.

Both units have 4 assessment objectives and are marked out of 24 per objective, 96 overall per unit.

Educational trips, visits and wider experiences

During the course you will have wider experiences that will enhance your knowledge and understanding. You will have the opportunity to take part in Life Drawing days at Bablake School, working with a life model and alongside other schools in the city.

An organised visit will take place to Birmingham to experience exhibitions in the Ikon Gallery, Digbeth Custard Factory and the German Christmas Market. Other potential visits will be to London to see the Art quarters of Shoreditch, Brixton and Camden Town.

What type of students will do well on this course?

Students who succeed on this course are interested in researching inspiration, have perseverance, good time management and independent working skills to realise your full creative potential.

For more information contact:

Mrs Stafford, Head of Art & Photography
Stafford.a1@barrshill.coventry.sch.uk

Mrs Bradbury, Assistant Headteacher
Bradbury.j@barrshill.coventry.sch.uk

Post-School Progression Opportunities

University	Entry requirements	Other similar courses offered
Coventry University Automotive and Transport Design (BA Hons)	BBC to include at least 1 Art subject	Foundation Art, Design & Media Practice (1 year) Architecture (BSc Hons) Product Design (BA Hons) Fine Art (BA Hons)
BCU Photography (BA Hons)	BBC/minimum of 112 UCAS points	Arts & Project Management (BA Hons with MA) Costume Design & Practice (BA Hons)
University of Northampton Games Art (BA Hons)	BCC at A-Level and a portfolio of own work	Games Design (BA Hons) Graphic Communication (BA Hons) Photography (BA Hons)

Career Opportunities

Forensic Artist



What would I do?

- Sketch composites of criminal suspects of unidentifiable persons
- Recreate skeletal, decomposed, or mutilated images using 2-D and 3-D computer imagery
- Create age progression sketches of suspects and missing persons
- Prepare diagrams, chart evidence boards and 3-D reconstructions of crime scenes for court hearings and other judicial proceedings
- Prepare reports, exhibits and displays for court proceedings
- Artistically enhance photographs

Salary: Starting: £23,500
UK average: £32,000
Routes in: Bachelor's degree

Architect



What would I do?

- Creating detailed technical plans using computer-aided design software
- Creating a plan, following building laws and safety regulations
- Working towards budgets
- Managing construction
- Checking building work and progress

Salary: Starting: £23,000
UK average: £42,555
Routes in: Relevant Bachelor's degree

Photographer



What would I do?

- Carry out research and preparation for a shoot
- Work in different locations and circumstances to get the right image
- Use an extensive range of technical equipment, including cameras, lenses, lighting and specialist software
- Communicate with photographic subjects to put them at ease, encourage them and direct them
- Liaise with other professionals, including graphic designers, writers, gallery managers, picture researchers, commissioning editors and art directors
- Compile finished products for sale, such as albums and framed prints
- Understand traditional film and digital photography and keep up to date with industry trends, developments and new techniques

Salary: Starting: £16,000
UK average: £42,000
Routes in: Relevant Bachelor's degree



Biology

At President Kennedy School we are committed to ensuring science students receive top quality teaching and learning experiences. Students will be taught by experienced members of staff who are passionate about their subject.

Students have the opportunity to learn new content but also to complete a number of core practicals to gain a practical endorsement. Alongside the course they will have opportunities and experiences to develop skills that will support them with their future aspirations.

Entry Requirements

To take A Level biology you need:

A grade 6 in triple Biology OR A grade 66 in Combined Science AND A grade 6 in Maths

Topics covered

Year 12 AS topics

- Topic 1: Biological Molecules
- Topic 2: Cells, Viruses and Reproduction of Living Things
- Topic 3: Classification and Biodiversity
- Topic 4: Exchange and Transport

Year 13 A2 topics

- Topic 5: Energy for Biological Processes
- Topic 6: Microbiology and Pathogens
- Topic 7: Modern Genetics.
- Topic 8: Origins of Genetic Variation
- Topic 9: Control Systems

Skills you will develop on the course

Throughout this course you will have the opportunity to develop the following skills:

- Confidence in carrying out and evaluating practicals
- Gaining an understanding of the ethical implications in science
- Debating controversial topics
- Critiquing of scientific articles

Assessment

There are three external exams sat in May/June at the end of year 13 and 16 core practicals internally assessed throughout the two years.

The external exams are:

- Paper 1: Advanced biochemistry, microbiology and genetics (30%)
- Paper 2: Advanced physiology, evolution and ecology (30%)
- Paper 3: General and practical principles in Biology (40%)

Educational trips, visits and wider experiences

We commit to organising visits for all students to Warwick or Coventry University where students will gain an insight into life as a Biology graduate, meeting university students and lecturers as well as conducting practicals in a university laboratory.

Students can apply to become a Biology Student Ambassador, where they can gain leadership skills and be involved with the organising and delivery of science clubs across all age ranges at President Kennedy School. In the spring term, we participate in the British Biology Olympiad Competition, competing against biology students across the country. There is an opportunity to enter the Foxcroft Science essay competition and for eligible students the opportunity to do a Nuffield Research Placement over the summer between Year 12 and 13. All students will also be given the opportunity to do their own research projects in Biology and gain the silver and gold CREST Award, which is internationally acknowledged. The subject provides regular copies of the Biology Review Magazine to explore biology beyond specification.

What type of students will do well on this course?

To do well on this course you need to be passionate about Biology, dedicated, demonstrate good time management and feel confident to seek support if necessary.

For more information contact:

Mr Green - KS5 Lead
greenj@pks.coventry.sch.uk

Mr Jhutti - Head of Science
jhuttim@pks.coventry.sch.uk

Mrs Mitchard - P16 Director
mitchard@pks.coventry.sch.uk

Mrs McVicar - KS4 Lead
hawesj@pks.coventry.sch.uk

Post-School Progression Opportunities

University	Entry requirements	Other similar courses offered
University of Birmingham Biological Sciences BSc (Hons)	AAB to include A Level biology and a second A Level science	Human Biology BSc (Hons) Human Biology with a year in professional placement BSc (Hons) Biological sciences with a study in Continental Europe BSc (Hons)
Coventry University Biomedical science	BBB to include A Level Biology	Biological and Forensic Science BSc (Hons) Human biosciences BSc (Hons) Pharmacology BSc (Hons)
Oxford University Biology BA	A*AA (with A* in Science or Maths and one other Science required)	Biology (MBiol) Human Sciences (MBiochem) Biochemistry BA (Hons)
University of Plymouth Marine Biology BSc (Hons)	120-144 UCAS Tariff points from a minimum of 3 A Levels including Biology	Conservation Biology BSc (Hons)
Aberystwyth University Biology and Climate Change	BBB to BBC to include A Level Biology	Marine and Freshwater Biology BSc (Hons) Plant Biology BSc (Hons) Animal Behaviour BSc (Hons) Biochemistry BSc (Hons) Environmental science BSc (Hons) Equine Science BSc (Hons)
University of Bristol Veterinary Sciences BVSc	AAA or A*AB to include chemistry and one other science	Veterinary Nursing BSc (Hons)

Career Opportunities

Microbiologist

What would I do?

- Monitor and identify microorganisms
- track microorganisms in a range of environments
- Monitor and assess samples from a range of sources
- Follow regular sampling schedules within a specific environment
- Use a variety of identification methods, including molecular techniques, to test samples
- Develop new techniques, products and processes
- Develop and plan methods to prevent the spread of disease
- Develop and register new medicines, vaccines, diagnostic tests and pharmaceutical products
- Plan, implement and evaluate new products in clinical trials
- Collect samples from different types of environments, such as agricultural sites
- Develop products such as enzymes, vitamins, hormones and antimicrobials
- Grow microbial cultures, e.g. for use in the food and drink industry or in agriculture
- Work with specialist computer software to undertake studies and research
- Manage and oversee laboratory work.

Salary: Starting: £32,000

UK average: £40,000 to £50,000

Routes in: Bachelor's degree in Biology, biomedical science

Pharmacologist

What would I do?

- Design, plan and conduct controlled experiments and/or clinical trials to improve understanding of a drug's activity
- Use computers, high technology measuring systems and other sophisticated equipment to collect, analyse and interpret data
- Apply and develop the results of research to work through a variety of applications, such as new products, processes, techniques and practices
- Draw up proposals for future developmental tests
- Organise and oversee tests of new drugs and medicines, ensure quality control and secure approval for their use
- Liaise with regulatory authorities to ensure compliance with local, national and international regulations
- Plan, coordinate and supervise the duties of other technical staff and train or mentor early-career pharmacologists.

Salary: Starting: £15,285

UK average: £40,000

Routes in: Bachelor's degree in Biology, Biomedical Science or Biochemistry

Genetic Counsellor

What would I do?

- Manage your own caseload of patients - through face-to-face interactions, over the phone and via video (virtual clinics)
- Take and interpret family and medical histories to calculate the risk of condition occurrence or recurrence
- Assess which genetic tests are most appropriate for each patient
- Order genetic tests and arrange medical and/or diagnostic testing of patients as well as testing of relatives
- Interpret genetic tests and explain them in easy to understand language to patients and their relatives
- Educate patients about inheritance patterns, testing, management, prevention, resources and research
- Use counselling skills to promote informed choices and help patients adapt to the risk or condition
- Refer patients for appropriate screening relating to their condition
- Deal with psychological and ethical issues raised by individuals and their families
- Keep patient records and write letters to patients
- Work with other medical and healthcare staff as part of a multidisciplinary team of genetic consultants, clinical scientists and other consultants to ensure appropriate follow-up of patients.

Salary: Starting: £31,000

UK average: £47,000 - £90,000.

Routes in: Bachelor's degree in Biology, Biomedical Science



Business

At President Kennedy School we are passionate about the subject of Business and developing a real love of the subject beyond Post 16. Part of our offer is to ensure students get real business experience to enable them to apply their knowledge. Teachers are highly skilled and committed to ensuring that opportunities are offered both in and out of the classroom. We also would encourage and support students in developing their wider employability skills to support with future careers employment.

Entry Requirements

Entry requirements for this BTEC Level 3 qualification are 5 grade 4s at GCSE including English and Maths. The business diploma qualification is worth the equivalent of 2 A'levels, so entry to courses will also need to include the grade achieved for their other subjects.

Topics covered

Core Content:

- Unit 1 Exploring Business
- Unit 2 Developing a Marketing Campaign
- Unit 3 Personal and Business Finance
- Unit 4 Managing an Event
- Unit 5 International Business
- Unit 6 Principles of Management

Plus optional content dependent on the interests of the group for example The English Legal System and Corporate Social Responsibility. Work experience and pitching for a new business idea.

Skills you will develop on the course

Students will develop a wide variety of skills including but not limited to:

- Research
- Presentation and communication
- Team working
- Critical thinking
- Data analysis
- Reflection

Assessment

The course is assessed through a variety of methods including coursework, controlled assessments and exams.

Educational trips, visits and wider experiences

In addition to the high quality teaching, students will be offered the following experiences:

- Attendance at a Business conference
- Visits to UK businesses
- Guest Speakers from the Business world and attendance at university guest lectures
- External "Leadership styles" workshops with Colourworks
- Completion of Open University qualifications
- Complete 40 hours of work experience

What type of students will do well on this course?

The course offers a broad introduction to the business sector and the functions that exist within different companies and organisations. It supports progression to higher education, including University and degree apprenticeships, so an interest in studying these subjects Post 18 is ideal.

For more information contact:

Mr Fogarty - fogarty@pks.coventry.sch.uk

Post-School Progression Opportunities

University	Entry requirements	Other similar courses offered
University of Warwick International Management (inc. year abroad) BSc (Hons)	152 UCAS points	International Business with Modern Languages Economics Global Sustainable Development and Business Studies
King's College London Business Management with Year in Industry BSc (Hons)	152 UCAS points	Economics and Management Accounting and Finance Management and Modern Languages
Durham University Accounting and Management with Placement Year – BA(Hons)	DDD	Accounting and Finance Economics Business and Management Marketing
City, University of London Business Management, Digital Innovation and Entrepreneurship BSc (Hons)	DDD	Business with Marketing International Business Financial Economics International Political Economy
Queen's University Belfast Finance (with a Year in Industry) BSc (Hons)	128 UCAS points	Business Economics BSc Actuarial Science and Risk Management BSc Accounting BSc Mathematics with Finance BSc

Career Opportunities

Business Development Manager

What would I do?

- Researching organisations to find new customers and identify who makes the decisions
- 'Cold calling' to arrange meetings at customers' premises
- Finding out what an organisation needs and working with a team to plan proposals and pricing
- Selling products and services to new and existing customers
- Negotiating with customers and building positive relationships
- attending events and conferences
- writing reports and making presentations to customers and senior management
- identifying new methods and opportunities for sales campaigns
- forecasting sales targets and making sure they're met
- delivering training to business developers and junior sales teams

UK average: £47,842

Routes in: With experience, you could progress to senior development manager, business development executive or marketing director.

Management Consultant

What would I do?

- Meeting clients to discuss what they need
- Carrying out research to gain an understanding of the client's business
- Interviewing managers, staff and customers
- Collecting and analysing data, and preparing reports
- Identifying and investigating issues, and planning how to tackle them
- Highlighting areas for improvement
- Creating computer models to test possible business solutions
- Presenting recommendations to the client
- Agreeing a course of action with the client
- Providing ongoing support to the client

UK average: £41,866

Routes in: With experience, you could become a partner in a management consultancy, work freelance or set up your own consultancy firm.

Chief Executive Officer (CEO)

What would I do?

- Setting out the organisation's aims and how it will meet them
- Making decisions about the organisation's priorities
- Working closely with a senior management team to put policies in place
- Managing relationships with partners
- making sure the organisation meets its legal obligations
- Reporting to the organisation's chairperson or owner
- Promoting the organisation at conferences, events and in the media
- Controlling budgets

UK average: £85,239

Routes in: You could also work as a management consultant, advising clients on commercial strategy and policy.



Chemistry

At President Kennedy School we are committed to ensuring science students receive top quality teaching and learning experiences. Students will be taught by experienced members of staff who are passionate about their subject.

Students have the opportunity to learn new content but also to complete a number of core practicals to gain a practical endorsement. Alongside the course they will have opportunities and experiences to develop skills that will support them with their future aspirations.

Entry Requirements

To take A Level Chemistry you need:

A grade 6 in triple Chemistry OR A grade 66 in combined Science AND A grade 6 in Maths

Topics covered

Year 1 (AS-level):

- Topic 1: Atomic Structure and the Periodic Table
- Topic 2: Bonding and Structure
- Topic 3: Redox I
- Topic 4: Inorganic Chemistry and the Periodic Table
- Topic 5: Formulae, Equations and Amounts of Substance
- Topic 6: Organic Chemistry I
- Topic 7: Modern Analytical Techniques I
- Topic 8: Energetics I
- Topic 9: Kinetics I
- Topic 10: Equilibrium I

Year 2 (A-level):

- Topic 11: Equilibrium II
- Topic 12: Acid-base Equilibria
- Topic 13: Energetics II
- Topic 14: Redox II
- Topic 15: Transition Metals
- Topic 16: Kinetics II
- Topic 17: Organic Chemistry II
- Topic 18: Organic Chemistry III
- Topic 19: Modern Analytical Techniques II

Skills you will develop on the course

Throughout this course you will have the opportunity to develop the following skills:

- Confidence in carrying out and evaluating practicals
- Gaining an understanding of the ethical implications in science
- Debating controversial topics
- Critiquing of scientific articles

Assessment

There are three external exams sat in May/June at the end of year 13 and 16 core practicals internally assessed throughout the two years.

The external exams are:

- Paper 1: Advanced Inorganic and Physical Chemistry (30%)
- Paper 2: Advanced Organic and Physical Chemistry (30%)
- Paper 3: General and Practical Principles in Chemistry (40%)

Educational trips, visits and wider experiences

We commit to organising visits for all students to Warwick University where students will gain an insight into life as a Chemistry graduate, meeting university students and lecturers. Students can apply to become Chemistry Student Ambassadors, where they can gain leadership skills and be involved with the organising and delivery of science clubs across all age ranges at Barr's Hill School. In the spring term, we participate in the Chemistry Olympiad International Competition, competing against chemistry students worldwide. For eligible students there is the opportunity to do a Nuffield Research Placement over the summer between year 12 and year 13. We attend a series of lectures at the University of Birmingham, which are currently online, where students can learn about the wider aspects and application of Chemistry outside of the curriculum and the current worldwide Chemistry topics being discussed. We will hopefully also be able to arrange a trip to industry, where students can see Chemistry in action. Students will be given the opportunity to do research projects in chemistry and gain the silver and gold CREST Award, which is internationally acknowledged.

The subject provides regular copies of the Chemistry Review Magazine to explore chemistry beyond specification, we also offer a Cambridge Chemistry Challenge and students are invited to participate in the RSC Schools analysis competition.

What type of students will do well on this course?

To do well on this course you need to be passionate about chemistry, dedicated, good time management and confident to seek support if necessary.

For more information contact:

Mr Green - KS5 Lead
greenj@pks.coventry.sch.uk

Mr Jhutti - Head of Science
jhuttim@pks.coventry.sch.uk

Mrs Mitchard - P16 Director
mitchard@pks.coventry.sch.uk

Mr Ratcliffe-Law - Science Teacher
ratcliffe-law@pks.coventry.sch.uk

Post-School Progression Opportunities

University	Entry requirements	Other similar courses offered
University of Birmingham Chemistry BSc	ABB to include A level Chemistry. Minimum Mathematics requirement GCSE grade 7.	Chemistry MSci Chemistry with Industrial Experience MSci Chemistry with Study Abroad MSci Chemistry with a Modern Language BSc/MSci Chemistry with Medicinal Chemistry and Drug Discovery BSc/MSci Chemistry with Business Management BSc/MSci
University of Warwick Chemistry BSc	AAB to include Chemistry and one of the following: Mathematics, Further Mathematics, Physics, Biology, Geology, Statistics or Computer Science.	Chemistry MChem Chemistry with Industrial Placement MChem Chemistry with International Placement MChem Chemistry with Medicinal Chemistry BSc/MChem Biochemistry BSc/MBio Biochemistry with Intercalated Year BSc/MBio
Oxford University Chemistry MChem	A*A*A (with both A*s in science subjects and/or Maths)	Biochemistry Biomedical Sciences Earth Sciences Materials Science
University of Lincoln Chemistry BSc	BBC, to include a grade B in Chemistry	Biomedical Science BSc Chemistry MChem Chemistry for drug discovery and development BSc/MChem Chemistry with Education BSc/MChem Chemistry with Mathematics BSc/MChem Biochemistry BSc/MChem Forensic Chemistry BSc/MChem

Career Opportunities

Analytical Chemist

What would I do?

- Analyse samples from various sources to
- Use analytical techniques and instrumentation, such as gas and high-performance liquid chromatography (HPLC), ion chromatography, electrochromatography and spectroscopy (infrared and ultraviolet, amongst others)
- Interpret data and meet strict guidelines on documentation when recording data
- Report scientific results
- Develop techniques for the analysis of drug products and chemicals
- Liaise with customers, staff and suppliers

Salary: Starting: £18,500

UK average: £25,000 - £40,000.

Routes in: Bachelor's degree in Chemistry

Biotechnologist

What would I do?

- Create, conduct and monitor experiments using live organisms or biomolecular processes in a laboratory setting to solve problems, improve processes and develop new products
- Use scientific knowledge to follow different methodologies to achieve results
- Perform data analysis on your experiments and interpret findings to support scientific investigations
- Record and disseminate results accurately in reports and via presentations
- Set up, maintain and operate standard laboratory equipment and computers

Salary: Starting: £20,000

UK average: £25,000 - £50,000

Routes in: Bachelor's degree in Chemistry or degree apprenticeship

Chemical Engineer

What would I do?

- Work closely with process chemists and control engineers to ensure the process plant is set up to provide maximum output levels and efficient running of the production facility
- Design plant and equipment configuration so that they can be readily adapted to suit the product range and the process technologies involved, taking environmental and economic aspects into account
- Set up scale-up and scale-down processes, including making appropriate changes, to equipment design and configuration
- Assess options for plant expansion or reconfiguration by developing and testing process simulation models
- Design, install and commission new production plants, including monitoring developments and troubleshooting
- Optimise production by analysing processes and compiling debottleneck studies
- Research new products from trial through to commercialisation and improve product lines.

Salary: Starting: £28,600

UK average: £30,000, - £54,000

Routes in: Bachelor's degree in Chemical Engineering



Computer Science

"Education should prepare students for jobs that don't yet exist, using technologies that haven't been invented, in order to solve problems we don't even know are problems yet."
Richard Riley

Computer Science starts with a blank screen and ends with changing the world. Bitcoin, Facebook, Google and iOS all began the same way: by opening a blank file and starting to type. We aim to deliver the skills you need to add to that list.

The subject is delivered across Post16 Select by some of the best specialists in the city, and provides an excellent base for progression on to university or the world of work. Our students develop excellent problem-solving skills and many are able to begin earning as freelancers before even finishing the course.

Entry Requirements

- 5 GCSEs at Grade 5 or above.
- High grades in Maths and Computer Science are desirable

Topics covered

Paper 1 – 40%

- 1.1 The Characteristics of contemporary processors, input, output and storage devices
- 1.2 Software and software development
- 1.3 Exchanging data
- 1.4 Data types, data structures and algorithms
- 1.5 Legal, moral, cultural and ethical issues

Paper 2 – 40%

- 2.1 Elements of computational thinking
- 2.2 Problem solving and programming
- 2.3 Algorithms

Skills you will develop on the course

- Building and maintaining of computers
- Coding in Python and JavaScript
- Web design in HTML and CSS
- Databases in SQL
- Technical understanding of the internet and networks

Assessment

- 40% - Exam – Computer Systems – 140 marks, 2hrs 30 minutes.
- 40% - Exam – Algorithms and Programming – 140 marks, 2hrs 30 minutes.
- 20% - Non-Exam Assessment – Programming project

Educational trips, visits and wider experiences

In A -Level Computer Science, you will have the opportunity to:

- Disassemble and reassemble computers.
- Learn to use 3D printers and create your own designs.
- Build and pilot robots.
- Build your own website using HTML and Bootstrap (and use your skills to make money as a freelancer).
- Meet industry experts in Cybersecurity, Data analytics and Healthcare and have a go at their work.

What type of students will do well on this course?

- Interested in computers and systems.
- Enjoys learning code and exploring new ideas.
- Likes getting stuck on a difficult problem and overcoming it.
- Good revision routines and self-study practice.
- Excited to learn more about the world!

Good indicators that Computer Science might be for you:

- Maths is one of your favourite subjects.
- You often learn new skills at home.
- You enjoy puzzle games and logic challenges.
- You've learned a bit of code already and would like to know more.

For more information contact:

- Talk to: Miss Finlayson - finlaysonj@pks.coventry.sch.uk
- Complete an hour of code on code.org

Post-School Progression Opportunities

University	Entry requirements	Other similar courses offered
Aston University Computer Science BSc(Hons)	BBB	Computer Science with Business BSc, Cybersecurity BSc, Electronic Engineering and Computer Science MEng
University of Bristol Computer Science and Electronics with Study Abroad MEng	ABB-AAA including Mathematics	Computer Science with Innovation MEng, Computer Science BSc,
Birmingham University BSc Computer Science with Digital Technology Partnership. (Apprenticeship with PwC)	AAA, must include Maths grade A	Computer Science BSc Artificial Intelligence and Computer Science BSc Computer Science with Study Abroad BSc

Career Opportunities

Python Developer

What would I do?

- Develop software for applications and websites.
- Create links between data and APIs, like Amazon Web Services.
- Use machine learning to predict the outcome of a range of activities, e.g. reducing financial trading.

Salary: Starting: £25,000

UK average: £57,500

Routes in: Bachelor's degree or significant experience in programming.

App Developer

What would I do?

- Supervise the work of programmers, technologists and technicians and other engineering and scientific personnel.
- Train users to use new or modified equipment.
- Specify power supply requirements and configuration.
- Recommend purchase of equipment to control dust, temperature, and humidity in area of system installation.
- Develop and direct software system testing and validation procedures, programming, and documentation.
- Modify existing software to correct errors, allow it to adapt to new hardware, or to improve its performance.
- Design, develop and modify software systems, using scientific analysis and mathematical models to predict and measure outcome and consequences of design.

Salary: Starting: £27,500

UK average: £44,055

Routes in: Bachelor's degree in Computer Science



Design and Technology

At Stoke Park School we are committed to ensuring our students receive top quality teaching and learning experiences. Students will be taught by experienced members of staff who are passionate about their subject. Students have the opportunity to learn new content and alongside the course, they will have numerous super curricular opportunities and experiences to develop skills that will support them with their future aspirations.

Entry Requirements

To take A Level Design you need:
5 grade 5 GCSEs including English Language

Topics covered

Year 12 topics

- Topic 1: Materials
- Topic 2: Performance characteristics of materials
- Topic 3: Processes, techniques and specialist tools
- Topic 4: Digital technologies
- Topic 5: Factors influencing the design of products
- Topic 6: Effects of technological developments

Year 13 topics

- Topic 7: Safe working Practices
- Topic 8: Features of manufacturing industries
- Topic 9: Designing for maintenance and the environment
- Topic 10: Current legislation
- Topic 11: Information handling, modelling and forward planning
- Topic 12: further processes and techniques

Skills you will develop on the course

Throughout this course you will have the opportunity to develop the following skills:

- Your ability to design Products of value, aesthetically and functionally
- Gaining an understanding of materials and processes applicable to the wider world
- Your ability to use a wide range of tools and equipment to product working products
- Evaluating and analyzing existing products and proposing solutions

Assessment

There is one external exam in Year 13 alongside a substantial design and make coursework that begins in year 12 and ends in May of year 13.

The external exam is:

Component 1: Principles of Design and Technology

Component 2: Independent Design and Make Project

Educational trips, visits and wider experiences

We commit to organising a range of guest speakers in Design and Technology, ranging from the engineering sector to F1 and prototyping. Students are able to lead on extra curricular clubs including an Art and Design club and a STEM club. Students are also able to develop their leadership skills and work with local primary schools to deliver Design and Technology classes to younger students as part of the transition experience.

What type of students will do well on this course?

To do well on this course you need to be passionate about Designing and making, dedicated to an extended piece of coursework and be able demonstrate your creative and problem solving skills to a wide range of problems. Keeping to strict deadlines is also a desirable characteristic.

For more information contact:

Mr Jandu - Head of Art and Design

DJandu@stokepark.coventry.sch.uk

Post-School Progression Opportunities

University	Entry requirements	Other similar courses offered
Nottingham Trent University Product Design Ba (Hons)	BBC	Furniture Design Ba (Hons) Product Design BSc (Hons)
Coventry University Product Design Ba (Hons)	BBC	Automotive and Transport BA (Hons) Graphic Design BA (Hons)
Edinburgh College of Art Product Design BA (Hons)	BBC	Graphic design BA (Hons) A range of Design courses including Animation, Fashion, Illustration, Textiles
Birmingham School of Architecture and Design Architecture Ba (Hons)	AAB preferably a Design course or Social Science	Art and Design Design Visualisation
Loughborough University Product Design and Technology BSc (Hons)	AAB preferably a Design course or Social Science	Design BA (Hons) Industrial design BA (Hons) Product Design Engineering BEng (Hons)
University of Leeds Product Design BSc	ABB ideally in Design and Technology	Mechanical Engineering BEng (Hons) Automotive engineering BEng (Hons)

Career Opportunities

Architect

What would I do?

- Create hand sketches, 3D models and detailed technical plans using computer aided design (CAD) software
- Create a plan, following building laws and safety regulations
- Find cost-effective ways to work within budgets
- Manage construction projects
- Choose or advise on materials
- Visit sites to check building work and progress
- Communicate and share ideas with clients, other architects, and architectural technologists and technicians
- Write reports and job proposals and complete planning applications.

Salary: Starting: £30,000
UK average: £30,000 to £45,000
Routes in: Bachelor's degree in Architecture

Product Designer

What would I do?

- Discuss what your client wants
- Investigate how existing products work or how services are used
- Develop ideas and make initial sketches or outline plans
- Decide on suitable materials or resources
- Use computer design software to produce detailed blueprints
- Make samples or working models, known as prototypes
- Test and refine designs

Salary: Starting: £15,285
UK average: £22,000 – £45,000
Routes in: Bachelor's degree in Product Design

Interior Designer

What would I do?

- Meet clients to discuss their requirements and ideas
- Develop designs to suit clients' needs, their budget, and the type of building
- Prepare initial sketches and mood boards for the client to approve
- Advise on use of space, colour schemes, fabrics, fittings and furniture
- Work out costs and prepare estimates
- Create detailed drawings from the initial sketches, usually on a computer
- Find suppliers of fittings, furniture, fabrics, and wall and floor coverings.

Salary: Starting: £31,000
UK average: £18,000 - £45,000
Routes in: Bachelor's degree in interior, Art and Design or Interior Architecture



Drama

At Stoke Park School we are committed to ensuring our students receive top quality teaching and learning experiences. Students will be taught by experienced members of staff who are passionate about their subject. Students have the opportunity to learn new content and alongside the course, they will have numerous super curricular opportunities and experiences to develop skills that will support them with their future aspirations.

Entry Requirements

To take Drama you need: A merit in drama AND a grade 5 in English

Topics covered

Year 12 AS topics

- CAPA 310: Approaches to Acting
- CAPA 306: Planning for a career in the creative and performing arts
- CAPA 315: Elizabethan or Jacobean Theatre
- CAPA 314: Drama in the community

Year 13 A2 topics

- CAPA 311: Auditions for Actors
- CAPA 313: Contemporary Theatre
- CAPA 304e: Performance preparation

Skills you will develop on the course

Throughout this course you will have the opportunity to develop all of the top 9 employment skills:

- Confidence
- Team building / people management / co- coordinating with others
- Emotional intelligence
- Negotiation
- Problem solving
- Critical thinking
- Creativity

Assessment

Each unit is assessed internally and a body of evidence is created, this will be a mixture of practical performances, research, presentations and evaluations.

The external exam is:

- CAPA 304e: Performance preparation

This is a brief that is released in the December of year 13. Students have set tasks with a time limitation which they will have to complete in controlled conditions. This is a mixture of research, performance and evaluation. This unit is worth 30% of the overall mark.

Educational trips, visits and wider experiences

We commit to organising visits that are available to all students such as theatre trips to watch performances and speak to industry professionals. As part of the careers unit we invite a wide range of industry professionals in from a range of roles from across the performing arts to speak to students about career progression in the industry. We also have theatre companies who visit and run workshops with the students. We work closely with other departments as well to explore cross curricular links through drama and theatre studies.

What type of students will do well on this course?

This course will suit anyone that wants to develop their confidence, team building, leadership, and problem solving and communication skills. Also, for anyone wanting to develop their knowledge and experience of Performing Arts in order to enter the Performing Arts industry. Performing Arts makes a great addition to your A Levels because it demonstrates your ability to learn and work in a variety of ways. This course is worth 1.5 A Levels.

For more information contact:

Miss Hall – Head of Performing Arts
lhall@stokepark.coventry.sch.uk

Post-School Progression Opportunities

University	Entry requirements	Other similar courses offered
Central Lancashire BA (Hons) Acting	96 UCAS points at A2	Theatre and Performance BA (Hons) Dance BA (Hons) Music Production and Performance BA (Hons)
University of Lincoln BA (Hons) Technical Theatre and Stage Management	UCAS Tariff - 112 points From a minimum of 3 A Levels or equivalent qualification	Drama and Theatre BA (Hons) Drama and English BA (Hons) Musical Theatre BA (Hons)
Royal Holloway Drama and Theatre Studies (BA)	A Levels: AAB-ABB At least five GCSEs at grade A*-C or 9-4 including English and Mathematics.	Drama with Film BA Drama and Philosophy BA Performing and Digital Arts
York University BA (Hons) Theatre Writing	A Levels: AAB 36 credits at Distinction and 9 credits at Merit or higher	Business of Creative Industries BA Film and Television Production BSc (Hons) Interactive Media BSc (Hons)
Cambridge University BA (Hons) Law	A Levels: A*AA	English BA (Hons)
University of Sheffield BA Journalism Studies	BBB + B in the EPQ 45 credits at Level 3, including 30 at Distinction and 15 at Merit	Music BMus Law LLB

Career Opportunities Actor

What would I do?

- Job seek and network
- Liaise with an agent
- Prepare for and attend auditions
- Learn lines and rehearse
- Research or undertake activities to help prepare for a part
- Discuss interpretation and delivery with other members of the company and the director
- Perform for a live audience
- Perform in a studio or on location for film, television, internet and radio broadcast
- Do voice-overs for advertisements or record audiobooks
- Manage the performance area, costumes and props
- Undertake activities associated with touring, such as driving a van, and 'get-ins' and 'get-outs' at theatres (i.e. setting up and dismantling the performance area)
- Liaise with venue managers and accommodation providers
Keep records for company managers
- Work as a walk-on or extra for television or film

Salary: £21,333

UK average: £25,350

Routes in: BA (Hons) Acting

Theatre Director

What would I do?

- Programming and budgeting
- Working with writers through workshops or script development schemes
- Adapting a script and, if the play is newly written, working with the writer or collaborating with playwrights
- Breaking down a script, analysing and exploring the content and conducting relevant research
- Translating and interpreting a script or musical score
- Holding auditions for productions, selecting and hiring designers, musicians, etc.
- Managing time and organising people and space
- Attending production meetings with set designers
- Organising rehearsals
- Communicating and liaising with all parties involved, including actors, the creative team, the production team and producers
- Attending preview performances and preparing detailed notes for the cast and for the creative and production teams
- Helping to publicise the production by giving interviews and leading discussions

Salary: Starting: £22,086

UK average: £34,221

Routes in: BA (Hons) Theatre
Writing, Directing and Performance

Dramatherapist

What would I do?

- Undertake assessment visits or appointments to evaluate and make decisions about treatment options for your clients
 - Plan and implement group and individual client dramatherapy treatments
 - Encourage and support your clients in creative drama and theatre work using techniques such as improvisation, storytelling, play, role play, masks, myth, ritual and script work
 - Encourage self-awareness, exploration and reflection on feelings and relationships
 - Initiate spontaneous exploration of personal issues
 - Use appropriate equipment, materials and therapeutic props, such as puppets
 - Organise and present a performance resulting from working with a group, if appropriate
 - Take referrals from other professionals such as psychologists, social workers, nurses, teachers and other therapist staff
 - Monitor and evaluate your clients' progress, writing reports on their progress and the activities that you've undertaken with them
 - Attend and contribute to team and multi-disciplinary meetings where appropriate
 - Attend regular supervision sessions
- Salary: Starting: (NHS) Band 6 (£31,365 rising to £37,890)
UK average: £38,890 - £73,664
Routes in: Drama and Theatre Studies (BA) and Dramatherapy MA



President
Kennedy
School
Building Brighter Futures



English Literature

A Level English Literature at President Kennedy School is a captivating and challenging course taught by a vibrant and experienced team of teachers. Our students achieve outstanding results and this enables them to progress to Higher Education as the course is highly regarded by universities nationally.

Building on the skills acquired at GCSE, A Level Literature explores significant texts from crucial eras in literary history, including seminal works covering a range of poetry, prose and drama. There are numerous enrichment opportunities available.

Entry Requirements

Students will be expected to achieve a grade 6 in English Literature or Language at GCSE.

Topics covered

This linear course will cover a range of poetry, prose and drama.

There will be three external examinations, part of which will assess the skills of unseen textual analysis.

One module will assess poetry both pre- and post-1900, as well as being able to respond to unseen poetry.

The second will assess Shakespeare as well as drama from pre- and post-1900.

The final examined unit will assess prose.

The combined total of these modules will contribute 80% of the overall marks. There will also be a prose-study coursework element, contributing the remaining 20% of the overall marks. Possible texts include John Keats, Othello, Poetry, Frankenstein, The Handmaid's Tale, A Streetcar Named Desire and others.

Skills you will develop on the course

Students will develop the skills to read, think and write in a critical and academic way. Students will study a range of texts from different periods within the 20th and 21st Century and this will enable them to sharpen their ability to attribute contextual depth and understanding to texts.

Assessment

Component 1 - Drama - 2 hour 15 minute examination - 30%

Component 2 - Poetry- 2 hour 15 minute examination - 30%

Component 3 - Prose - 1 hour examination - 20%

Component 4 - Prose study- 3000 word coursework essay- 20%

Educational trips, visits and wider experiences

We commit to going to see a play at Shakespeare's famous stage 'The Globe', visit Bristol University for taster sessions, work with and meet a journalist, visit The Library of Birmingham and visit Paris to further understand the city of Paris for the anthology component of Unit 1.

What type of students will do well on this course?

Students who will do well on this course are those who have a love and a passion for English. Students need to be prepared to read, think and speak critically and discuss critical theory and ideas amongst their peers. Students need to be driven and motivated.

For more information contact:

Mrs Jones – jonesj@pks.coventry.sch.uk.

Mrs Soutter Pettitt - pettitt@pks.coventry.sch.uk

Post-School Progression Opportunities

University	Entry requirements	Other similar courses offered
Loughborough University English BA (Hons)	AAB including English (Literature, Language or both)	English with Business Studies (BA) English with Creative Writing (BA) Liberal Arts (BA)
University of York English BA (Hons)	AAA/A*AB including an A in English Literature (English Language and Literature is also acceptable)	English and Philosophy (BA) English and History (BA) English and Politics (BA)
University of Bristol English BA (Hons)	AAA including English Literature or combined English Literature and Language	English with study abroad (BA) English and Classical Studies (BA)

Career Opportunities

Digital Copywriter

What would I do?

- Understand your target audience - you're not writing for the client, you're writing for their readers, so you'll need to know what interests them
- Identify key messages - understand the main thing that you want the reader to feel and do and how to communicate this powerfully
- Work with creative teams to ensure that the visual elements of the webpage complement the words

Salary: Starting: Starting salaries for junior copywriters are between £22,000 and £30,000 per year or you can work as a freelancer and determine your own wage.

Routes in: Bachelor degree in English

Secondary School English teacher

What would I do?

- As a secondary school teacher you'll teach pupils aged 11 to 18. Specialising in a particular subject, you'll plan, teach and assess lessons in line with curriculum objectives.
- You'll aim to ensure a healthy culture of learning and will support, observe and record pupils' progress.
- Teachers must keep up to date with developments in their subject area, new resources, methods and national objectives. The role involves liaising and networking with other professionals, parents and carers, both informally and formally.

Salary: Starting: New entrants to the profession in England start on the main salary scale, which rises incrementally from £25,714 to £36,961.

Routes in: Relevant Bachelor's degree and PGCE

Web Content Manager

What would I do?

- Manage your company CMS, working with developers and editors to ensure it's meeting the needs of your organisation
- Conduct content audits to identify gaps and redundancies in the site content
- Create and implement content schedules for people to produce or update content

Salary: Starting: Experienced web content coordinators, web content executives and web content managers can earn between £25,000 and £40,000.

Routes in: Relevant Bachelor's degree



English Language and Literature

English Language and Literature at Barr's Hill School remains a popular subject for A Level study and supports students in developing skills that are useful for many other areas of study and employment. English Language and Literature is an A Level designed with a focus on the integration of language and literature. It enables students to see how linguistic and literary methods are related and to explore these links in their work.

Entry Requirements

Students will be expected to achieve a grade 6 in English Literature or Language at GCSE.

Topics covered

Unit 1: Telling Stories

Telling stories covers a range of themes from "Remembered Places" in our Paris Anthology and "Imagined Worlds" in "The Handmaid's Tale" to Duffy's "Poetic Voice". The unit integrates methods of language analysis across the genres. It is assessed through a three-hour examination.

Unit 2: Exploring Conflict

In this unit we examine themes from "Dramatic Encounters" focusing on the conflict within Tennessee Williams' 'A Streetcar Named Desire' to writing about society and role of individuals in F. Scott Fitzgerald's 'The Great Gatsby'. The unit also provides the opportunity for creative writing and critical evaluation. Assessment is through a two-and-a-half-hour examination.

Unit 3: Non-Examination Assessment – Making Connections

The unit provides the opportunity for a personal investigation on a chosen theme in a literary and non-literary text of the student's choice, culminating in an extended essay of 2500-3000 words.

Skills you will develop on the course

Students will develop the skills to read, think and write in a critical and academic way. Students will study a range of texts from different periods within the 20th and 21st Century and this will enable them to sharpen their ability to attribute contextual depth and understanding to texts.

Assessment

There are two exams and one coursework element. The exams form 80% of the grade and coursework accounts for 20% of the course grade.

Educational trips, visits and wider experiences

We commit to going to see a play at Shakespeare's famous stage 'The Globe', visit Bristol University for taster sessions, work with and meet a journalist, visit The Library of Birmingham and visit Paris to further understand the city of Paris for the anthology component of Unit 1.

What type of students will do well on this course?

Students who will do well on this course are those who have a love and a passion for English. Students need to be prepared to read, think and speak critically and discuss critical theory and ideas amongst their peers. Students need to be driven and motivated.

For more information contact:

Miss Donaldson – Donaldson.k@barrshill.coventry.sch.uk

Post-School Progression Opportunities

University	Entry requirements	Other similar courses offered
Loughborough University English BA (Hons)	AAB including English (Literature, Language or both)	English with Business Studies (BA) English with Creative Writing (BA) Liberal Arts (BA)
University of York English BA (Hons)	AAA/A*AB including an A in English Literature (English Language and Literature is also acceptable)	English and Philosophy (BA) English and History (BA) English and Politics (BA)
University of Bristol English BA (Hons)	AAA including English Literature or combined English Literature and Language	English with study abroad (BA) English and Classical Studies (BA)

Career Opportunities

Digital Copywriter

What would I do?

- understand your target audience - you're not writing for the client, you're writing for their readers, so you'll need to know what interests them
- identify key messages - understand the main thing that you want the reader to feel and do and how to communicate this powerfully
- work with creative teams to ensure that the visual elements of the webpage complement the words

Salary: Starting: Starting salaries for junior copywriters are between £22,000 and £30,000 per year or you can work as a freelancer and determine your own wage.

Routes in: Bachelor degree in English

Secondary School English teacher

What would I do?

- As a secondary school teacher you'll teach pupils aged 11 to 18. Specialising in a particular subject, you'll plan, teach and assess lessons in line with curriculum objectives.
- You'll aim to ensure a healthy culture of learning and will support, observe and record pupils' progress.
- Teachers must keep up to date with developments in their subject area, new resources, methods and national objectives. The role involves liaising and networking with other professionals, parents and carers, both informally and formally.

Salary: Starting: New entrants to the profession in England start on the main salary scale, which rises incrementally from £25,714 to £36,961.

Routes in: Relevant Bachelor's degree and PGCE

Web Content Manager

What would I do?

- manage your company CMS, working with developers and editors to ensure it's meeting the needs of your organisation
- conduct content audits to identify gaps and redundancies in the site content
- create and implement content schedules for people to produce or update content

Salary: Starting: Experienced web content coordinators, web content executives and web content managers can earn between £25,000 and £40,000.

Routes in: Relevant Bachelor's degree



Geography

We at President Kennedy School are committed to ensuring students receive top quality teaching and learning experiences. Students will be taught by experienced members of staff. Alongside the course they will have character building opportunities to support them with their future aspirations to inspire a love for Geography and the world around them. The Geography curriculum also ensures that pupils are well equipped with the crucial skills and knowledge that are essential for a wide range of careers.

Entry Requirements

5 GCSEs Grades 5+ (ideally a GCSE at 5+ in Geography)

Topics covered

Component 1: Physical Geography:

1. Tectonic Hazards
2. Coastal landscapes
3. Water insecurity
4. Carbon and energy

Component 2: Human Geography

1. Globalisation
2. Diverse Places
3. Superpowers
4. Health and human rights

Synoptic themes

1. Players
2. Attitudes and actions
3. Futures and uncertainties

Skills you will develop on the course

Geography students have the opportunity to apply for subject leadership roles to complement their A-Level studies. These offer excellent character-building opportunities which are important when considering university and employment applications. Opportunities include discussing their passion for the subject with lower year groups, supporting with P16 Select Geography Open Evening and leadership skills by supporting or running subject enrichment.

Assessment

Paper 1: Physical Geography: 2 hours 15, 30% of A-Level
Paper 2: Human Geography: 2 hours 15, 30% of A-Level
Paper 3: Synoptic paper: 2 hours 15, 20% of A-level
NEA Coursework: 20% of A-Level

Educational trips, visits and wider experiences

Students will also have the opportunity to undertake a number of fieldtrips in a variety of locations to support with the NEA coursework element of the course. Students will have the opportunity to attend a residential trip in Wales. These trips are an excellent way of developing fieldwork skills such as data collection and a great way of seeing more of the world we live in.

What type of students will do well on this course?

We are looking for hard working and passionate Geographers who are interested in the world around them and the influence (both positive and negative) that humans have on it. Geography is a fantastic subject for those studying Science and also complements Human Geographers who are looking to study Social Sciences and English.

For more information contact:

Dr Campbell - campbellj@pks.coventry.sch.uk

Mr Allen - allenj@pks.coventry.sch.uk

Post-School Progression Opportunities

University	Entry requirements	Other similar courses offered
University of St Andrews BSc (Hons) Geography	AAA/ABB	Sustainable Development BSc
London School of Economics BA (Hons) Geography	AAA	BA Geography BSc Geography with Economics BSc Environmental Policy with Economics
Coventry University Geography BA (Hons)	BBC	Geography and Natural Hazards BSc (Hons) Geography BSc (Hons)

Career Opportunities

Environmental Consultancy:

What would I do?

- Work to ensure that their commercial or government clients comply with regulations and address a variety of environmental issues
- This is a varied role, typically focusing on identifying whether an area of land, air or water is polluted, and what the impact would be.
- Working with local authorities, architects and town planners to understand the impact of future developments on the environment and how they can be minimized.

UK average: £35,000-£45,000

Routes in: Bachelor's degree

Landscape Architect:

What would I do?

- meeting with clients to discuss their needs
- surveying sites to look at existing plant and animal life, and natural resources
- getting the views of local residents, businesses and other people who use the site
- using CAD packages to draw up ideas for clients to choose from
- presenting your design ideas to clients
- drawing up contracts and managing the tendering process for contractors
- writing reports and environmental impact assessments
- giving evidence to public enquiries
- monitoring the progress of projects

UK average: £42,930

Routes in: With experience, you could move on to a supervisory or management position, become a partner in a private practice, or set up your own practice.

Quantity Surveyor:

What would I do?

- finding out a client's needs and assessing if their plans are feasible
- working out quantities and costs of materials, time and labour for tenders
- negotiating contracts and work schedules
- advising on legal matters, including risks and disputes
- monitoring sub-contractors and stages of construction
- writing regular reports on costs and preparing accounts for payment
- keeping up to date with construction methods and materials

UK average: £47,213

Routes in: With experience, you could become a senior quantity surveyor or move into senior project management, supply chain management, consultancy work or self-employment.



President
Kennedy
School
Building Brighter Futures



STOKE PARK
SCHOOL

Health & Social Care

The BTEC Level 3 in Health and Social Care qualification at President Kennedy School is designed to provide highly specialist, work-related experiences in a range of health and social care settings.

The course enables learners to gain an in-depth knowledge and understanding of current issues in health and social care, as well as develop transferable skills that will prepare them for employment within this field.

It prepares learners for employment in the health and social care sector and offers a sound academic foundation for further study in higher education.

Entry Requirements

Entry requirements for this BTEC Level 3 qualification are 5 grade 4s at GCSE including English and Maths

Topics covered

YEAR 12	YEAR 13
Human growth and Development	Enquiries into current research
Working in Health and Social Care	Meeting the individual needs
Anatomy and Physiology	Physiological Disorders and their care
Work Experience	Public Health
Health and Safety	Health Psychology
Complementary Therapies	Infection, prevention and control
Caring for people with Dementia	

Skills you will develop on the course

- Problem-solving
- Quantitative Reasoning
- Analysing and interpreting data
- Critical thinking
- Time Management

Assessment

4 units externally assessed through exams, and 9 Units assessed through internal coursework.

- Unit 1 Human Growth and Development
- Unit 2 Working in HSC
- Unit 3 Anatomy and physiology
- Unit 4 Enquiries into current research

Students will also sit unit tests at the end of each topic, and Year 12 Synoptic assessments which will help determine their predicted grades for University.

Educational trips, visits and wider experiences

- Occupational Webinars
- Special School Games
- Summer School
- Health School

What type of students will do well on this course?

You will need to be passionate about understanding and caring for others, and have an ambition for a career in the Health sector.

For more information contact:

Ms Miller - Leader of Health & Social Care
millers@pks.coventry.sch.uk

Post-School Progression Opportunities

University	Entry requirements	Other similar courses offered
University of Liverpool, Nursing BN(Hons)	BTEC: DDD (all distinctions)	Adult Nursing BSc, Child Nursing BSc, Learning disabilities Nursing BSc, Mental Health Nursing BSc.
Keele University, Public Health	DMM	Health Promotion and Public Health (BSc), Public Health and Wellbeing (BA) Public Health and Community studies (BA)
University of Coventry, Biomedical Science BSc	DDM	Medical Biochemistry (BSc) Biochemistry (BSc) Food and Nutrition Science (BSc) Healthcare Science (BSc)

Career Opportunities

Adult Nurse

What would I do?

- Take temperatures, blood pressures and pulse rates
- Give drugs and injections, treat wounds and set up drips
- Monitor the progress of patients and update records
- Handover information to colleagues at the end of a shift
- Work with doctors and other healthcare professionals to decide what care to give
- Give advice to patients and their relatives

Salary: Starting: £27,055

UK average: £40,588

Routes in: Relevant Bachelor's degree

Health Promotion Specialist

What would I do?

- Promote healthy eating and regular exercise
- Advise of the dangers of smoking or excessive drinking
- Give information about the risk of coronary heart disease and cancers
- Raise awareness of mental health, sexual health and drug misuse

Salary: Starting: £21,000

UK average: £40,000

Routes in: Relevant Bachelor's degree or an apprenticeship

Biomedical Scientist

What would I do?

- Test for diseases like Legionnaires' disease and food poisoning
- Test for infectious diseases like rubella or hepatitis
- Analyse blood samples and monitor organ function
- Support the blood transfusion and transplant service through blood grouping and matching
- Test for blood abnormalities and diseases, like anaemia and leukaemia
- Process and analyse tissue samples from operations and autopsies
- Use specialist procedures like cell culture to detect cancer
- Routinely test fluid and tissue samples like cervical smear tests
- Update paperwork or computer records with data and test results

Salary: Starting: £25,655

UK average: £45,839

Routes in: Relevant Bachelor's degree



History

The history staff at President Kennedy School are all specialists in their fields of study. They will support you on every step of your Post-16 journey to ensure you achieve the greatest academic success possible. This support will come in the form of one-to-one support in and out of lessons, organisational skills, revision and intervention sessions. Over the course of two years not only will you build your in-depth historical knowledge across a range of topics, but you will also develop expert skills of time management, organisation, analysis and argument. These skills will give you a strong foundation as a historian and academic writer and go on to support your future studies or employment.

Entry Requirements

In order to succeed at A Level history, you need a good level of literacy, a fascination with the world around you and a willingness to read and ask questions.

Topics covered

There are four modules as part of the A Level. Three compulsory exam units and once coursework Unit. In Year 12 you will study Britain Transformed 1918-97 and USA Boom, Bust and Recovery 1920-1955 to fully examine the theme of "Democracy in change". In Year 13 you will study Britain 1780 – 1928 a political history and you will choose a coursework module.

Skills you will develop on the course

You will develop many skills of the expert history, and these skills will hold you in good stead for future study in a wide range of subjects. You will learn how to access and read detailed text, develop effective skills of argument both orally and written. Further you will learn how to research and develop your own hypotheses along side being able to analyse sources in detail to put them in context.

Assessment

Assessment is as follows:

- Unit 1 Britain Transformed -Written exam 30%
- Unit 2 USA Boom, Bust and Recovery 20%
- Unit 3 Britain Protest, Agitation and Reform - Written exam 30%
- Coursework – under controlled conditions 20%

Educational trips, visits and wider experiences

Opportunities:

Each year a select number of pupils will have the opportunity to visit Auschwitz and complete a range of in depth holocaust studies.

There will also be a chance to visit the national research centre in London

Many of our students support Debate Club and assist in lower school classes

What type of students will do well on this course?

A student with a passion and enthusiasm for history and a willingness to work hard. You will also need to be organised and collaborative if necessary.

For more information contact:

To find our more please speak to any of the teachers in the History Department.

Mr Finney - finney@pks.coventry.sch.uk

Mrs Wilkinson - wilkinson@pks.coventry.sch.uk

Post-School Progression Opportunities

University	Entry requirements	Other similar courses offered
University of Cambridge History BA(Hons)	A*AA inc A Level History	History and Politics History and Modern Languages History of Art
University of St.Andrews Modern History MA (Hons)	AAA inc History A Level	Medieval History Middle East Studies Ancient History Medieval History and Archaeology
Royal Holloway University of London Ancient History BA (Hons)	BBB-ABB	History and Philosophy Modern Languages and History Classical Archaeology and Ancient History History Politics and International Relations
University of Bristol History BA (Hons)	AAA-ABB including History	English and History History with Languages Ancient History History with Innovation
Manchester Metropolitan University History BA(Hons)	BBC-BCC	History and Politics English and History History and International Relations Art History and Curating

Career Opportunities

Historian

What would I do?

- Present historical accounts in terms of individuals or social, ethnic, political, economic, or geographic groupings.
- Teach and conduct research in colleges, universities, museums, and other research agencies and schools.
- Interview people to gather information about historical events and to record oral histories.
- Organise information for publication and for other means of dissemination, such as use in CD-ROMs or Internet sites.
- Trace historical development in a particular field, such as social, cultural, political, or diplomatic history.
- Conduct historical research, and publish or present findings and theories.
- Research and prepare manuscripts in support of public programming and the development of exhibits at historic sites, museums, libraries, and archives.
- Conserve and preserve manuscripts, records, and other artifacts.
- Collect detailed information on individuals for use in biographies.
- Organise data, and analyze and interpret its authenticity and relative significance.

UK average: £32,296

Routes in: A large majority of historians combine teaching, writing and research at colleges and universities. You can also work as consultant in various domains.

Solicitor

What would I do?

- Providing legal services like conveyancing, probate, civil and family law, litigation, personal injury and criminal law
- Advising businesses and corporate clients in areas like contract law, tax, employment law and company sales and mergers
- Advising on insurance, patents, shipping, banking, the media or entertainment
- Providing advice in areas like education, planning and social services
- Advising government ministers
- Prosecuting people who break rules
- Advising and representing clients in court
- Instructing barristers or advocates to act for clients
- Drafting confidential letters and contracts
- Researching legal records and case law
- Attending meetings and negotiations
- Managing finances and preparing papers for court
- Using plain English to explaining complex legal matters to clients
- Keeping up to date with changes in the law

UK average: £43,194

Routes in: Bachelor Degree in Law.

Archivist

What would I do?

- Storing materials correctly and keeping them in good condition
- Identifying, dating, cataloguing and indexing archive materials
- Helping people use the archives
- Making records available to users in formats such as photocopies, microfiche and online
- Carrying out research
- Giving talks and organising presentations, displays and exhibitions
- Negotiating the buying or donation of archive material

UK average: £26,433

Routes in: With experience, you could work with larger and more prestigious organisations, like national archives and museums, businesses, church foundations and charities.



Barr's Hill School
Building Brighter Futures

President
Kennedy
School

Building Brighter Futures



STOKE PARK
SCHOOL



Information Technology

At President Kennedy School we are passionate about the subject of IT and developing a real love of the subject beyond Post 16. Part of our offer is to ensure students get real business experience to enable them to apply their knowledge.

Teachers are highly skilled and committed to ensuring that opportunities are offered both in and out of the classroom.

Entry Requirements

Entry requirements for this BTEC Level 3 qualification are 5 grade 4s at GCSE including English and Maths.

Topics covered

Core Content:

Unit 1 Information Technology Systems
Unit 2 Creating Systems to Manage Information
Unit 3 Using Social Media in Business
Unit 6 Website Development

Skills you will develop on the course

Students will develop a wide variety of skills including but not limited to:

- Research
- Presentation and communication
- Team working
- Critical thinking
- Data analysis

Assessment

The course is assessed through a variety of methods including coursework, controlled assessments and exams.

Educational trips, visits and wider experiences

Within IT we offer experiences to enrich students learning and knowledge within this subject discipline such as:

- IT ambassadors supporting students across the school with their understanding within the area of Information Technology and developing practical skills relevant to the workplace.
- Running of a coding club to develop students knowledge with programming skills in various languages. This also supports the development of being able to debug and problem solve identifying aspects of code which do not execute effectively.
- Educational trips looking at advancements in the technological world as well as ways it is used within industry.

What type of students will do well on this course?

The course offers an in depth introduction to the IT world. It is designed for students who are interested in an introduction to the study of creating IT systems to manage and share information alongside other fields of study, with a view to progressing to a wide range of higher education courses, not necessarily in IT. It supports progression to higher education, including University and degree apprenticeships, so an interest in studying these subjects Post 18 is ideal.

For more information contact:

Mrs Matharu - Leader of I.T
matharu@pks.coventry.sch.uk

Post-School Progression Opportunities

University	Entry requirements	Other similar courses offered
University of Warwick Computer Science BSc (Hons)	152 UCAS points	Artificial Intelligence Cyber Security Computer Science with Mathematics
Aston University Cyber Security BSc (Hons)	DDD	Forensic Analyst Threat Analyst
University of Westminster Computer Games Development with Placement Year – BSc(Hons)	DDM	Object-orientated design Programming development
Oxford Brookes University Information Technology for Business BSc (Hons)	DDD	Business and Finance Education and IT Information Technology Management
Coventry University Ethical Hacking (with a Year in Industry) BSc (Hons)	DDM	Animation Software Artificial Intelligence Software development

Career Opportunities

Software Developer

What would I do?

- Producing clean, efficient code based on specifications
- Testing and deploying programs and systems
- Fixing and improving existing software
- Work with developers to design algorithms and flowcharts
- Produce clean, efficient code based on specifications
- Integrate software components and third-party programs
- Verify and deploy programs and systems
- Troubleshoot, debug and upgrade existing software
- Gather and evaluate user feedback
- Recommend and execute improvements
- Create technical documentation for reference and reporting

Salary: Starting: £39,943

Routes in: With experience, you could progress to senior development manager, and executive level positions.

Forensic Computer Analyst

What would I do?

- Secure a system or device so it can't be tampered with
- Use a range of forensic tools and software to extract and analyse data
- Recover damaged, deleted or access hidden, protected or encrypted files
- Unlock digital images that are locked to hide the identity of a place or person
- Examine data from mobile phones and satellite navigation systems to trace people or places
- Collect information and evidence in a legally admissible way
- Write technical reports based on your findings and, if required, give evidence in court as an expert witness
- Present findings of on-going incidents to other members in the investigation team, law enforcement agencies and clients
- Keep up to date with evolving cybercrime methods and developments within the digital forensics field
- Undergo security checks and vetting procedures
- Work to relevant ISO accreditations.

Salary: Starting: £ 40,000

Routes in: With experience, you could progress to a senior analyst role and head of security.

IT Consultant

What would I do?

- Work with clients to determine requirements and define the scope of a project
- Plan timescales and the resources needed
- Clarify a client's system specifications, understand their work practices and the nature of their business
- Travel to customer sites • liaise with staff at all levels of a client organisation
- Define software, hardware and network requirements
- Analyse IT requirements within companies and give independent and objective advice on the use of IT
- Develop agreed solutions and implement new systems
- Present solutions in written or oral reports
- Help clients with change-management activities
- Purchase systems where appropriate
- Design, test, install and monitor new systems
- Prepare documentation and present progress reports to customers
- Organise training for users and other consultants
- Be involved in sales and support, and where appropriate, maintain contact with client organisations
- Identify potential clients and build and maintain contacts.

Salary: Starting: £82,299

Routes in: You could also work as an IT consultant contracting.



President
Kennedy
School

Building Brighter Futures



STOKE PARK
— SCHOOL —

Law

In Law at President Kennedy School, we are committed to supporting you develop a deeper understanding of your rights and the structure of UK society through the exploration of legal theories, cases and the nature of the English legal system. Teaching will be led by high quality subject specialists. You will be introduced to a variety of laws, cases, legal explanations and theories, and you will be develop a number of skills that will support you in applying for higher education and employment opportunities.

Entry Requirements

5 GCSEs at Grade 5 or above, including English and Maths

Topics covered

The nature of law and the English legal system
Criminal law
Tort law
Human rights

Skills you will develop on the course

Whilst increasing your knowledge of laws, cases, legal theories and explanations, you will also develop the following skills:

Application of legal knowledge to contemporary and historical examples
Analysis of cases and legal theories
Synthesis of cross-curricular concepts
Evaluation of laws, cases and legal theories

Assessment

There are three external papers sat in May/June at the end of your final year (13).
Paper 1: the nature of law and the English legal system & Criminal law, 2 hours, 33%
Paper 2: the nature of law and the English legal system & Tort law, 2 hours, 33%
Paper 3: the nature of law and the English legal system & Human rights, 2 hours, 33%

Educational trips, visits and wider experiences

To further enhance students' legal knowledge and appreciation of the subject, students will visit and attend Law masterclasses in some of the world's leading universities for Law. Students will also experience talks from leading legal academics and lawyers to help further widen their career ambitions.

What type of students will do well on this course?

You will need excellent communication skills, have a thirst for knowledge, be an independent learner, work effectively with others, research skills, suitable intellectual abilities, be aware of what is happening in the wider world and a critical thinker.

For more information contact:

Mr Dang - Leader of Psychology & Teacher of Law
DANGB@pks.coventry.sch.uk

Post-School Progression Opportunities

University	Entry requirements	Other similar courses offered
UCL (University College London) Law LLB (Hons)	A*, A, A (at least two from the university's list of preferred A Level subjects) and GCSE English Language and Maths at Grade B or 6	Law LLB with French Law (Hons) Law LLB with German Law (Hons) Law with Another Legal System (Hons)
University of Birmingham LLB Law (Hons)	A, A, A	LLB Law with Business (Hons) LLB Law with Criminology (Hons) LLB International Law & Globalisation (Hons)
Nottingham Trent University LLB Law (Hons)	120 UCAS Tariff points from up to four qualifications (two of which must be A Level equivalent)	Business Law LLB (Hons) Law with Psychology LLB (Hons) International Law LLB (Hons)

Career Opportunities

Barrister, Solicitor or Legal Executive

What would I do?

- Represent clients in a range of legal matters from criminal and civil matters, financial and family issues, immigration, human rights and advocating in courts.

Salary: Starting: £33,426
UK average: £70,474 (can be as much as £100,000+)

Routes in: Bachelor's degree accredited by the British Psychological Society and at least three years postgraduate study. Can be sponsored and trained by the NHS

Political Risk Analyst

What would I do?

- Working with companies or governments to examine such issues as crime levels, government stability, financial regulations or humanitarian and human rights.

Salary: Starting: £32,000
UK average: £41,815 (can be as much as £80,000+)

Routes in: An LLB or another social sciences/humanities degree, a related Masters would be useful and sometimes a PhD. Work experience would be beneficial in such areas as research and data analytics, having commercial/political/government experience and time spent working in field you're interested in.

Civil Servant

What would I do?

- Working with governments (local and national) to implement laws efficiently and fairly, making sure that many parts of society run smoothly. They work in many areas of life i.e. pensions, the environment, the media, education, law enforcement, science, technology, finance, the armed forces, national security and many more. A Law degree would therefore be very useful.

Salary: Starting: £21,460
UK average: £31,930 (can be as much as £76,490)

Routes in: Register and take an aptitude test to check your qualifications and abilities. Attend an interview where you will be asked about your background, the areas you're interested in and how you would be able to use your skills and abilities. You will also be referenced, which means a thorough check on your education and work history as well as your financial position, contact will be made with former schools/universities and employers as well as family members. This is to ensure that you are eligible for a security clearance.



Mathematics

Students studying A-Level Mathematics at President Kennedy School will be driven to achieve exceptional academic success and will be highly motivated to take their mathematical skills to the next destination following their studies.

This course will reveal opportunities into career paths students have not yet explored.

Mathematics at President Kennedy School will help students develop fundamental problem-solving, critical thinking and analytical skills. We have a team of high-quality Mathematics teachers who will support and encourage students throughout the two-year course.

Entry Requirements

Grade 6 in GCSE Mathematics

Topics covered

PURE MATHS	MECHANICS	STATISTICS
Proof	Quantities and units in Mechanics	Statistical Sampling
Algebra and Functions	Kinematics	Data presentation and interpretation
Coordinate Geometry	Forces and Newton's laws	Probability
Sequences and Series	Moments	Statistical distributions
Trigonometry		Statistical hypothesis testing
Exponentials and Logarithms		
Differentiation and Integration		
Numerical Methods and Vectors		

Skills you will develop on the course

- Problem-solving
- Quantitative Reasoning
- Analysing and interpreting data
- Critical thinking
- Time Management

Assessment

100% exam at the end of year 13:

- Paper 1: Pure Maths, 100 marks, 2 hours.
- Paper 2: Pure Maths, 100 marks, 2 hours.
- Paper 3: Applied Maths, 50 marks Statistics, 50 marks Mechanics, 2 hours.

Students will also sit unit tests at the end of each topic, and year 12 Synoptic assessments which will help determine their predicted grades for University.

Educational trips, visits and wider experiences

- We will organise trips to universities, such as the University of Warwick, where students have the opportunity to attend Maths workshops and visit the maths department.
- Students have chance to enter national mathematics competitions such as the Senior Maths Challenge and Maths Olympiad for Girls.
- Students have the chance to enrol in regular problem-solving classes at the University of Warwick which will help prepare them for competitive university entrance test such as STEP, TMUA, or the MAT.

What type of students will do well on this course?

Students who are motivated to study Mathematics at a higher level and have the ambition for a career involving Mathematics. Students should be resilient and determined, and ready to face a challenging but extremely rewarding A-level course.

For more information contact:

Mr Adams - Joint Head of Maths
adamsc2@pks.coventry.sch.uk

Mr Hodson - Joint Head of Maths
hodson@pks.coventry.sch.uk

Post-School Progression Opportunities

University	Entry requirements	Other similar courses offered
University of Warwick Engineering BEng (Hons)	AAA that includes Mathematics	Civil Engineering BEng Electrical and Electronic Engineering BEng Mechanical Engineering BEng
University of Sheffield Economics BSc (Hons)	AAB that includes Mathematics	Economics & Mathematics BSc Financial Mathematics BSc Economics with Finance BSc
University of Leicester Mathematics and Artificial Intelligence BSc (Hons)	ABB that includes Mathematics	Mathematics MMath Mathematics BSc Mathematics and Actuarial Science BSc

Career Opportunities

Data Scientist

What would I do?

- work closely with your business to identify issues and use data to propose solutions for effective decision making
- use machine learning tools and statistical techniques to produce solutions to problems
- stay curious and enthusiastic about using algorithms to solve problems and enthuse others to see the benefit of your work
- use machine learning tools and statistical techniques to produce solutions to problems

Salary: Starting: £25,000

UK average: £50,000

Routes in: Relevant Bachelor's degree

Software Developer

What would I do?

- talking through requirements with the client and the development team
- taking part in technical design and progress meetings
- writing or amending computer code
- testing software and fixing problems

Salary: Starting: £20,000

UK average: £40,000

Routes in: Relevant Bachelor's degree / Apprenticeship

Aerospace Engineer

What would I do?

- developing navigation, communications or weapons systems
- researching ways to make fuel-efficient parts, such as wings, fuselage and engines
- using CAD software for design
- testing prototypes
- collecting and analysing test data
- planning and supervising the fitting of aircraft and components

Salary: Starting: £20,000

UK average: £40,000

Routes in: Relevant Bachelor's degree



Further Mathematics

Further Mathematics A-Level at President Kennedy School is designed for the very brightest and most able Mathematicians - you must have a love of Mathematics and be prepared to tackle challenging and demanding problems. The mathematics and the skills that you learn will prepare you excellently for future study in any mathematical related field and prepare you to study at the most highly selective universities. Further Mathematics A-Level is an extension of A-Level Mathematics, and you must take A-Level Mathematics alongside A-Level Further Mathematics to access the course.

Entry Requirements

Grade 6 in GCSE Mathematics

Topics covered

CORE PURE MATHS	FURTHER MECHANICS	DECISION MATHEMATICS
Proof	Momentum and Impulse	Algorithms and Graph Theory
Complex Numbers	Work, Energy and Power	Algorithms on Graphs
Matrices	Elastic strings and springs and elastic energy	Algorithms on Graphs II
Further Algebra and Functions	Elastic Collisions in 1 dimension	Critical Path Analysis
Further Calculus	Elastic Collisions in 2 dimensions	Linear Programming
Further Vectors		
Polar Coordinates		
Hyperbolic Functions		
Differential Equations		

Skills you will develop on the course

- Problem-solving
- Critical thinking
- Quantitative Reasoning
- Analysing and interpreting data

Assessment

Students will sit 4 exam papers at the end of year 13 which will count for 100% of their overall mark.

- Paper 1: Core Pure Maths, 75 marks, 90 minutes.
- Paper 2: Core Pure Maths, 75 marks, 90 minutes.
- Paper 3: Further Mechanics, 75 marks, 90 minutes.
- Paper 4: Decision Mathematics, 75 marks, 90 minutes.

Educational trips, visits and wider experiences

- We will organise trips to universities, such as the University of Warwick, where students have the opportunity to attend Maths workshops and visit the maths department.
- Students have chance to enter national mathematics competitions such as the Senior Maths Challenge and Maths Olympiad for Girls.
- Students have the chance to enrol in regular problem-solving classes at the University of Warwick which will help prepare them for competitive university entrance test such as STEP, TMUA, or the MAT.

What type of students will do well on this course?

Students who love mathematics and are really excited about having 10 hours of Maths and Further Maths lessons a week. You most love getting stuck into difficult problems, and be determined to find solutions.

For more information contact:

Mr Hodson - Joint Head of Maths
hodson@pks.coventry.sch.uk

Mr Adams - Joint Head of Maths
adamsc2@pks.coventry.sch.uk

Post-School Progression Opportunities

University	Entry requirements	Other similar courses offered
University of Bath Mathematics BSc (Hons)	A*AA including A*A in Mathematics and Further Mathematics	Other similar courses offered: Mathematics MMath, Mathematics and Statistics BSc, Mathematics Statistics and Data Science BSc
University of Cambridge, Kings College Computer Science Meng	A*A*A including Mathematics and Further Mathematics, and TMUA admissions assessment	Engineering MEng, Mathematics MMath, Natural Science MSci
University of Warwick, Mathematics, Operational Research, Statistics, Economics (MORSE), BSc	A*A*A to include A*A* in Mathematics and Further Mathematics	Data Science BSc, Mathematics and Statistics BSc, Discrete Mathematics BSc

Career Opportunities

Actuary

What would I do?

- Use mathematical modelling techniques and statistical concepts to determine probability and assess risks, for example, analysing pension scheme liabilities to price commercial insurance
- Analyse statistical data in order to make calculations, for example, accident rates for particular groups of people
- Be an effective communicator, to discuss and explain complex topics in a simple way
- Present reports, explaining their implications to managers and directors and advising on risk limitation

Salary: Starting: £30,000

UK average: £55,000

Routes in: Relevant Bachelor's degree

Research Scientist Maths

What would I do?

- Use specialist mathematical software such as Mathematica, MATLAB or Mathcad or programming languages such as C/C++ to develop programs to perform mathematical functions
- Produce original mathematics research
- Identify solutions by learning and applying new methods, for example designing mathematical models that interpret data in a meaningful way
- Attend, and sometimes present at, national and international scientific conferences and meetings in your particular field of interest

Salary: Starting: £15,000

UK average: £35,000

Routes in: Relevant Bachelor's degree and PhD

Operational Researcher

What would I do?

- Collect and analyse data and develop models, often using spreadsheets, databases and pragmatic, numerical approaches to solve problems
- Use analytical methods, such as simulation, network analysis, decision analysis, multi-criteria analysis, scenario analysis, soft-systems modelling, optimisation, game theory and queuing theory
- Compile a report of findings and make presentations to clients, often requiring clear and persuasive explanation of complex processes to a non-technical audience, in order to help them make decisions

Salary: Starting: £24,000

UK average: £50,000

Routes in: Relevant Bachelor's degree and PhD



Media Studies

At Stoke Park School we are committed to ensuring our students receive top quality teaching and learning experiences. Students will be taught by experienced members of staff who are passionate about their subject. Students have the opportunity to learn new content and alongside the course, they will have numerous super curricular opportunities and experiences to develop skills that will support them with their future aspirations.

Entry Requirements

To take A Level Media Studies you need:

Five grade 5s including GCSE English Language. GCSE Media Studies is a bonus but not essential.

Topics covered

Year 12 AS topics

- Analysing Media Language and Representation in advertising, marketing, newspapers and/or music videos
- Understanding Media Industries and Audiences including advertising, marketing, film, radio, newspaper and video games within their media contexts

Year 13 A2 topics

- Television in the Global Age
- Magazines, Mainstream and Alternative Media
- Media in the Online Age

Skills you will develop on the course

Throughout this course you will have the opportunity to develop the following skills:

- Interpret and analyse texts
- Utilise your creativity through your production work
- Debate meanings using a theoretical framework
- Evaluate how the media influences and is shaped by the world around us

Assessment

There are three external exams sat in May/June at the end of year 13 and a 3000 – 4000 word essay on a topic of your choice. The external exams are:

- Paper 1: Media topics, Industries and Audiences (35%)
- Paper 2: Media Forms and Products in Depth (35%)
- NEA: Cross Media Production choice (30%)

Educational trips, visits and wider experiences

The Media Studies department feels passionately about enhancing students' knowledge about the world around them. Through industry days, university visits and links with the BBC, BBfC and BFI, students have a range of opportunities to learn about the different industries but also experience them first-hand. Our super curricular provision also ensures that students can complete short courses on different areas of interest.

What type of students will do well on this course?

To do well on this course you need to be interested in the world around you and have an interest in what influences our society. You should be interested in a range of media and be up-to-date with current events and industries. You should also be well organised and enjoy analysing texts and their appeal to their audiences over time.

For more information contact:

Mr Gaiser – Head of Media Studies
sgaiser@stokepark.coventry.sch.uk

Post-School Progression Opportunities

University	Entry requirements	Other similar courses offered
University of Brighton Bachelor of Arts BA (Hons)	BBB – BBC including A Level Media Studies	2D Animation Film Studies
University of Portsmouth Bachelor of Arts BA (Hons)	ABB including A Level Media Studies	Journalism Film Studies and Media
University of Leeds Bachelor of Arts BA	AAB - ABB including A Level Media Studies	Cultural and Media Studies with a Year in the Industry
University of Kent Bachelor of Arts BA	BBB including A Level Media Studies	Film and Media Studies Film Studies with a Year in the Industry
University of Aberystwyth Bachelor of Arts BA	BBB - BBC including A Level History	Media and Communication Studies

Career Opportunities

Historian

What would I do?

- Present historical accounts in terms of individuals or social, ethnic, political, economic, or geographic groupings.
- Teach and conduct research in colleges, universities, museums, and other research agencies and schools.
- Interview people to gather information about historical events and to record oral histories.
- Organize information for publication and for other means of dissemination, such as use in CD-ROMs or Internet sites.
- Trace historical development in a particular field, such as social, cultural, political, or diplomatic history.
- Conduct historical research, and publish or present findings and theories.
- Research and prepare manuscripts in support of public programming and the development of exhibits at historic sites, museums, libraries, and archives.
- Conserve and preserve manuscripts, records, and other artifacts.
- Collect detailed information on individuals for use in biographies.
- Organise data, and analyze and interpret its authenticity and relative significance.

Salary: Starting: £27,000

UK average: £32,000 to £40,000

Routes in: Bachelor's degree in history, Masters or PhD in history

Journalist

What would I do?

- Investigating a story as soon as it breaks
- Following up potential leads and developing new contacts
- Interviewing people face-to-face and over the phone
- Attending press conferences
- Recording meetings and interviews using recording equipment or shorthand
- Coming up with ideas for stories and features
- Writing up articles in a style that will appeal to the reader
- Sub-editing other reporters' articles for publication
- Writing up articles for online publication

Salary: Starting: £35,500

UK average: £40,000

Routes in: Bachelor's degree in history

Costume Designer

What would I do?

- Discussing ideas with the production designer, director, and make-up, set and lighting designers
- Creating costume ideas to fit the production's design concept and budget
- Researching suitable costume styles, fabrics and designs
- sketching costume designs
- giving instructions to costume makers

On smaller productions, you might also carry out some of the practical tasks, like:

- Managing the wardrobe budget
- Buying or hiring outfits
- Fitting, altering and adapting costumes
- Cleaning, ironing and mending
- Making sure wardrobe items are available at the right time
- Keeping the look of the costumes the same between shoots or scenes

Salary: Starting: £25,000

UK average: £28 500 - £34,000.

Routes in: Bachelor's degree in history



Music

At Stoke Park School we are committed to ensuring our students receive top quality teaching and learning experiences. Students will be taught by experienced members of staff who are passionate about their subject. Students have the opportunity to learn new content and alongside the course, they will have numerous super curricular opportunities and experiences to develop skills that will support them with their future aspirations.

Entry Requirements

To take RSL Music you need:

The standard entry requirements for Stoke Park Sixth form GCSE/BTEC or RSL Music at a grade 6 or Merit OR you can demonstrate competency on an instrument or show a high standard portfolio

Topics covered

Year 1 Units

- Unit 349 – Planning a Career in Music
- Unit 362 – Lead Performer OR Unit 370 Studio Sound Recording OR Music Management
- Unit 355 – Leading a Music Making Activity
- Unit 320 – Music Dissertation

Year 2 Units

- Optional Choice Unit – Chosen by the learner
 - Exam Unit – based on your chosen pathway
 - Unit 387 – Rehearsal Skills and Live Performance
 - Unit 388 – Live Sound recording and sound reinforcement
 - Unit 389 – Music Promotion and Event Management
-

Skills you will develop on the course

Throughout this course you will have the opportunity to develop the following skills depending on your pathway choice:

- Performance Skills – Rehearsal and live performance skills, musicianship, development of repertoire.
 - Technology Skills – Sound recording, sequencing and production, mixing and mastering.
 - Business Skills – Sound business and financial skills, promotion and marketing, artist management and event management skills.
-

Assessment

70% of units are internally assessed and externally moderated. In year 2 the external exam unit worth 30% is externally marked.

The external exams are: (305)

- Unit 387 – Rehearsal Skills and Live Performance
 - Unit 388 – Live Sound recording and sound reinforcement
 - Unit 389 – Music Promotion and Event Management
-

Educational trips, visits and wider experiences

Students will get regular opportunities to perform in school and out of school in other venues. We have previously had musicians perform at the Empire, Godiva festival, Belgrade Theatre and Warwick Arts Centre. Students get the opportunity to work with music professionals through tuition and masterclasses. We work closely with a number of music organisations and collaborate with music studios and performance venues. We have annually trips to the theatre and have experience opportunities to watch different music performances including orchestras, operas and Festivals.

What type of students will do well on this course?

To do well on this course you need to be passionate about Music and dedicated to improving your performance/ technology or music business skills. You should demonstrate commitment and reliability.

For more information contact:

Miss Kennedy – Head of Music
lkennedy@Stokepark.coventry.sch.uk

Post-School Progression Opportunities

University	Entry requirements	Other similar courses offered
University of Liverpool BA (Hons) Music/ Popular Music	A Levels ABB BTEC/RSL In Music in Lieu of A Level Music And/Or Grade 8 in an instrument	Music and Technology BA (Hons) Popular Music (Hons) Music BA (Hons)
Royal Birmingham Conservatoire BMus (Hons) Performance	UCAS Tariff - 32 points Admission Test Audition at grade 8+ standard	BMus (Hons) Music Technology BMus (Hons) Composition BMus (Hons) Jazz
BIMM University BMus (Hons) Popular Music Performance	UCAS Tariff - 32 points At least five GCSEs at grade A*-C or 9-4 including English and Mathematics.	BA (Hons) Event Management BA (Hons) Electronic Music Production BA (Hons) Music and Sound Production
University of Surrey BMus (Hons) Creative Music Technology	UCAS Tariff – 120-144 A Levels BBB Portfolio of work	BSC (Hons) Mathematics with Music BMus (Hons) Music BA (Hons) Actor-Musician
Royal Holloway, University of London BA (Hons) Music and Theatre	UCAS Tariff – 128-160 A Levels AAB	BMus (Hons) Music Technology BA (Hons) Performing and Digital Arts BMus (Hons) Music

Career Opportunities

Pop Musician

What would I do?

- Practising and rehearsing
- Playing live in front of an audience
- Composing music
- Taking part in recording sessions
- Promoting your music by contacting agents and record companies, using social media, sending people demonstration ('demo') recordings, setting up a website
- Arranging gigs and tours (or dealing with a manager or agent who does this for you) You'll often need to combine music with other types of work, particularly at the start of your career.

UK average: £30,628

National per gig rate: £139-£186

Routes in: BMus in Popular Music

Music Therapist

What would I do?

You'll encourage clients to explore sound and communicate through music, to help them with:

- Expressing themselves
- Developing insight and creating ways of relating to other people
- Becoming aware of their feelings
- Interacting with other people more confidently
- Bringing about positive changes in their lives
- You'll hold group and one-to-one therapy sessions with clients who have:
 - Learning disabilities
 - Emotional, behaviour or mental health problems
 - Speech and language difficulties
 - An injury or illness or are recovering from an addiction

You'll monitor the effectiveness of the therapy sessions, and write case notes and reports.

If you're working in the NHS, you'll work closely with other health care professionals like nurses, physiotherapists, occupational therapists, psychologists and speech and language therapists.

UK average: £34,164

Hourly rate: £40-£60

Routes in: BA or BMus in Music and a postgraduate course accredited by BAMT

Music Producer

What would I do?

Music producers help to create recordings and live performances of music. Depending on your specialism, you might:

- Create music for films, advertisements, or games (which might include writing, arranging, and mastering)
 - Work with artists, musicians, and sound engineers in a recording studio, making sure each song achieves the sound they're striving for
 - Work on live concerts and festivals, coordinating technical staff and performers to help events run smoothly
- Whether you specialise in recordings or live music, you'll be responsible for the overall quality of the finished product and a large part of your role will be managing other people. This could include:
- Creating a schedule or budget and making sure everyone sticks to it
 - Arranging meetings and recording sessions
 - Inspiring confidence in musicians and helping to resolve disputes between them
 - Contributing ideas and feedback at all stages of the process (such as during a song recording)
- Increasingly, music producers also take on sound engineering responsibilities, so the role often includes sound design and audio editing.

UK average Salary: £37,361

Routes in: Degree in Music production/technology



Philosophy and Ethics

At President Kennedy School we deliver an incredibly popular and highly successful course that challenges and develops students to prepare them for the moral and ethical challenges of the modern world.

Delivered by experienced teachers and Philosophy graduates students are given an outstanding learning experience.

Students who choose philosophy and ethics have the unique opportunity to explore a variety of philosophical viewpoints and explore the impact they have had, and continue to have on the world. An excellent, and highly regarded choice for any student who is looking to apply for Law, Medicine, Psychology or Criminology.

Entry Requirements

To take A Level Philosophy and Ethics you need:

A grade 5 in English, a GCSE grade 5 in RE is preferable but not always necessary.

Topics covered

	Year 12 AS topics Philosophy of Religion	Year 12 AS topics Religion and Ethics	Year 13 A2 topics Development in religious thought (Christian)
	Ancient Philosophical influences	Normative ethical theories	Religious beliefs, values and teachings, their interconnections and how they vary historically
	The nature of the mind, body and soul	The application of ethical theories to two contemporary issues of importance	Sources of religious wisdom and authority
	Arguments about the existence/ non-existence of God	Ethical Language and thought	Practices which shape and express religious identity
	The nature and impact of religious experience	Debates around the significant idea of conscience	Significant social and historical developments in theology and religious thought
	The Problem of Evil	Sexual ethics and the influence on ethical thought of developments in religious beliefs	Key themes related to religion and society
	The Nature of God		
	Issues with religious language		

Skills you will develop on the course

Throughout this course you will have the opportunity to develop the following skills:

- Confidence in debating and evaluating controversial ethical issues like feminism and euthanasia
- Gaining an understanding of the ethical implications across medicine, politics, identity and many more.
- Critiquing of original philosophical texts

Assessment

There are three external exams sat in May/June at the end of year 13

The external exams are:

- Paper 1: Philosophy of Religion (33%)
- Paper 2: Religion and Ethics (33%)
- Paper 3: The Development of Christian thought (33%)

Educational trips, visits and wider experiences

We commit to organising visits both in and outside of President Kennedy School. We have close links with the Charity Echo Eternal and have the privilege of regular visits from a Holocaust survivor Peter Lantos. His ethics as a survivor are a testament to what the human spirit can endure.

Post 16 students are given the unique opportunity to discuss his journey to forgiveness and his unique views on evil and suffering.

This year, we are also offering students the opportunity to attend a joint trip to Italy with Geography. A real chance to experience and explore Christian culture and heritage and discuss Christian ethics with experts. It is a trip that will develop and enhance any student's UCAS form and directly support our curriculum.

What type of students will do well on this course?

To do well on this course you need to be passionate about Ethics, debate and interested in exploring the questions not finding the answer. They will need to be curious, dedicated and feel confident to seek support if necessary.

For more information contact:

Mrs Starbuck - Leader of RE
Starbuck@pks.coventry.sch.uk

Miss Rejali - Teacher of RE
rejalis@pks.coventry.sch.uk

Post-School Progression Opportunities

University	Entry requirements	Other similar courses offered
University of Birmingham LLB Law	A*AA (BTECs accepted) Philosophy and Ethics is one of the preferred A levels	LLB Law with Criminology LLB Law with Business LLB Law with International law and globalisation
Coventry University International Relations BA Hons	BBC Philosophy and Ethics is one of the preferred A levels	Politics (BA Hons) History (BA Hons)
Oxford University Philosophy and Theology BA	AAA Philosophy and Ethics is one of the preferred A levels	Classics and Philosophy (BA) Computer science and Philosophy (BA) Physics and Philosophy (BSC)
University of Manchester International Disaster Management & Humanitarian Response BSc	LAWAAB to ABB	Business and management (BA) Geography (BA)
Goldsmiths University of London Journalism	ABB or BTEC DDM	Media and Communication (BA Hons) History and Journalism (BA Hons)

Career Opportunities

Conflict Resolution Officer at the UN

What would I do?

- Support strategic and operational planning by advising the ASG and the Chief of Office on matters relating to the effective direction of office operations, assisting with the preparation, implementation and monitoring of the office work plan and actively contributing to the development of solutions to operational issues that may arise.
- Monitor implementation of the compact between the Secretary-General and the ASG, and advise on any necessary action to meet targets.
- Coordinate and collate input to management and inter-governmental bodies especially on budgetary as well as administrative matters.
- Provide needed operational support and guidance to the Office's regional branches on administrative matters.
- Support the Chief of Office, including with coordination and information management, by acting as focal point for administrative activities related to human resources and budgetary matters, implement special projects (e.g. team retreats) under the Office's work programme and prepare related materials for the Chief of Office.

Salary: Starting: 45,000
UK average: £40,000 to £150,000
Routes in: Bachelor's degree in International relations or politics

Bio Ethics researcher

What would I do?

- Bioethics researchers use their advanced understanding of biology, medicine, and ethics to create rigorous evidence as they develop their own research at universities and hospitals.
- A bioethics researcher utilizes bioethics principles and may participate in biological research or advise others in the field of biological and medical research on the ethical nature of their ongoing inquiries and discoveries.
- Bioethics research professionals pave the way for new discoveries while abiding by human rights laws, ethical regulations, government regulatory standards, and other standards and rules that are applicable in this industry.
- Those with experience researching in healthcare ethics handle confidential information while working to enhance health systems through their important work.

Salary: Starting: £25,000
UK average: £40,000
Routes in: Bachelors degree in Ethics and Biology

Human Rights Lawyer

What would I do?

Given the range of areas that are affected by human rights, the day-to-day responsibilities of a human rights lawyer could vary greatly. Here are some of the tasks that you might take on:

- Advocating on behalf of victims of human rights violations
- Advising clients and making sure they are aware of their rights
- Talking to clients and witnesses to gather statements
- Writing legal documents for each case
- Researching previous cases
- Negotiating with lawyers representing other parties
- Ensuring that any agreements reached are implemented.

There are many projects around the world that greatly value the help of human rights lawyers. For example, Article 19 (who take their name from the 19th article of the UDHR) helps people exercise their rights to freedom of opinion and expression. The Right to Education Initiative envisions a future where access to education is available world-wide.

Interested in women's rights? The UN Women site lists plenty of opportunities to get involved. Amnesty International also runs many human rights campaigns across the globe.

Salary: Starting: £31,000
UK average: £65,000 - £125,000
Routes in: LLB Law with International law and globalisation, LLB LAW AAB

Physics



At President Kennedy School we are committed to ensuring Science students receive top quality teaching and learning experiences.

Students will be taught by experienced members of staff who are passionate about their subject.

Students have the opportunity to learn new content but also to complete a number of core practicals to gain a practical endorsement. Alongside the course they will have opportunities and experiences to develop skills that will support them with their future aspirations.

Entry Requirements

To take A Level Physics you need:

A grade 6 in triple Physics OR A grade 66 in combined Science AND A grade 6 in Maths

Topics covered

- Topic 1: Working as a Physicist
- Topic 2: Mechanics
- Topic 3: Electric Circuits
- Topic 4 Materials
- Topic 5: Waves and Particle Nature of Light
- Topic 6: Further Mechanics
- Topic 7: Electric and Magnetic Fields
- Topic 8: Nuclear and Particle Physics
- Topic 9: Thermodynamics
- Topic 10: Space
- Topic 11: Nuclear Radiation
- Topic 12: Gravitational Fields
- Topic 13: Oscillations

Skills you will develop on the course

Throughout this course you will have the opportunity to develop the following skills:

- Confidence in carrying out and evaluating practicals
- Gaining an understanding of the ethical implications in science
- Debating controversial topics
- Critiquing of scientific articles

Assessment

There are three external exams sat in May/June at the end of Year 13 and 16 core practicals internally assessed throughout the two years.

The external exams are:

- Paper 1: Advanced Physics I (30%)
- Paper 2: Advanced Physics II (30%)
- Paper 3: General and Practical Principles in Physics (40%)

Educational trips, visits and wider experiences

We commit to organising a visit for all students to Warwick University where students will gain an insight into life as a Physics graduate, meeting university students and lecturers. Students can apply to become a Physics Student Ambassador, where they can gain leadership skills and be involved with the organising and delivery of science clubs across all age ranges at Barr's Hill School. In the spring term, we participate in the British Physics Olympiad Competition, competing against physics students across the country. For eligible students there is the opportunity to do a Nuffield Research Placement over the summer between Year 12 and year 13. We attend a series of online lectures by Northumbria University, where students can learn about the wider aspects and application of physics outside of the curriculum and the current worldwide physics topics being discussed. Students will be given the opportunity to do research projects in physics and gain the silver and gold CREST Award, which is internationally acknowledged. We also hope to arrange a trip to industry, where students can see physics in action, with the potential of this being a trip to CERN in Switzerland to see the Hadron Collider.

The subject provides regular copies of the Physics Review Magazine to explore physics beyond specification.

What type of students will do well on this course?

To do well on this course you need to be passionate about physics, dedicated, demonstrate good time management and feel confident to seek support if necessary.

For more information contact:

Mr Green - KS5 Lead
greenj@pks.coventry.sch.uk

Mr Jhutti - Head of Science
jhuttim@pks.coventry.sch.uk

Mrs Mitchard - P16 Director
mitchard@pks.coventry.sch.uk

Post-School Progression Opportunities

University	Entry requirements	Other similar courses offered
University of Birmingham Physics BSc	A*AA / AAAA to include A level Physics and Mathematics	Physics MSci Physics (International Study) BSc/MSci Physics and Astrophysics BSc/MSci Physics and Astrophysics (International Study) BSc/MSci Physics with Particle Physics and Cosmology BSc/MSci Theoretical Physics BSc/MSci
Coventry University Physics BSc	BBB to include A Level Physics and A Level Mathematics 4 in English Language and Maths	Physics MPhys Mathematics and Physics BSc Cloud computing BSc
Oxford University Physics BA	A*AA (with A* in physics or Maths)	Physics MPhys
Northumbria University Physics BSc	120 UCAS points Grade B in A-level Mathematics and Physics 4 in Maths and English Language	Physics MPhys Physics with Astrophysics BSc/MPhys Electrical and Electronic Engineering BEng Civil Engineering BEng
University of Leicester General Engineering BEng	ABB including Maths and Physics Grade 4 in English Language	General Engineering MEng Aerospace Engineering BEng/Meng Mechanical Engineering BEng/Meng Software Engineering BEng/Meng Computer Science BEng/Meng Physics BEng/Meng Physics with Astrophysics BEng/Meng

Career Opportunities

Electrical Engineer

What would I do?

- identify customer requirements
- design systems and products
- read design specifications and technical drawings
- make models and prototypes of products using three-dimensional design software
- communicate with clients and contractors
- record, analyse and interpret test data
- propose modifications and retest products

Salary: Starting: £20,000

UK average: £60,000

Routes in: Bachelor's degree in degree in Electrical or Electronic Engineering

Medical Physicist

What would I do?

- commission, assess and ensure the safe operation of specialist equipment used by medical staff in areas such as radiotherapy, ultrasound, nuclear medicine, laser technology and physiological monitoring
- plan and supervise radiotherapy treatment in discussion with medical and other staff
- speak with patients to explain treatment procedures and possible side effects
- liaise closely with doctors to add technical results to patient reports
- oversee the quality control of equipment to ensure that correct and consistent results or outputs are achieved and ensure that ongoing maintenance routines are followed
- make audit visits to hospital departments to check compliance with health and safety legislation

Salary: Starting: £ 31,365

UK average: £45,753 - £104,927

Routes in: Bachelor's degree in Physics followed by NHS Scientist Training Programme

Research Scientist

What would I do?

- plan and conduct experiments to record, investigate and analyse scientific phenomena
- operate complex instrumentation
- extrapolate data to develop theories to explain phenomena
- develop new products and ways of applying new methodology
- in industry, ensure that the manufacture of new products and materials can be carried out without problems regardless of scale
- manage a research team (which may include technicians and support staff), or a group of research students in an academic department
- teach or lecture students.

Salary: Starting: £15,285

UK average: £50,000 - £75,000.

Routes in: Bachelor's degree in Physics



Politics

Studying Politics will give you an opportunity to be fully informed on a fundamental part of our society, giving us the knowledge to help us understand that if we engage in political processes, using the pressure points built into the system, then every individual really does have the opportunity to change the world. Looking specifically at the UK political system as well as a comparative section on US politics, this course offers students the chance to see how change can happen in the world. At Barr's Hill you will receive the support from staff who have specialized knowledge in the subject and can offer bespoke one to one support which will help you build knowledge and skills that will prepare you to be an active citizen in the world.

Entry Requirements

In order to succeed at A Level Politics, you need a good level of literacy, an interest in how the world works and change happens.

Topics covered

There are three modules as part of the A Level. Three compulsory exam units. In Year 12, you will study UK Politics. In Year 13 you will study US politics.

Skills you will develop on the course

There are lot of transferable skills such as assertiveness, public speaking, data analysis, essay writing and research. As well as written and oratory skills.

Assessment

- UK Politics 33%
 - UK Government 33%
 - Comparative Politics USA - 33%
-

Educational trips, visits and wider experiences

- We will have a visit to parliament where will we receive a tour and workshop on the history of parliament.
 - A range of essay writing competitions will be offered for pupils who want to challenge themselves and enhance their UCAS personal statements
-

What type of students will do well on this course?

A student who wants to understand how the world works and wants to make change. You will also need to be organized and collaborative.

For more information contact:

To find our more please speak to any of the teachers in the history department.

Mr Mahon - mahon.s@barrshill.coventry.sch.uk

Mrs Martin - martin.e@barrshill.coventry.sch.uk

Miss Wilcox - wilcox.A@barrshill.coventry.sch.uk

Post-School Progression Opportunities

University	Entry requirements	Other similar courses offered
University of Cambridge History BA(Hons)	A*AA inc A Level History	History and Politics History and Modern Languages History of Art
University of St.Andrews Modern History MA (Hons)	AAA inc History A Level	Medieval History Middle East Studies Ancient History Medieval History and Archaeology
Royal Holloway University of London Ancient History BA (Hons)	BBB-ABB	History and Philosophy Modern Languages and History Classical Archaeology and Ancient History History
University of Bristol History BA (Hons)	AAA-ABB including History	English and History History with Languages Ancient History History with Innovation
Manchester Metropolitan University History BA(Hons)	BBC-BCC	History and Politics English and History History and International Relations Art History and Curating

Career Opportunities

Historian

What would I do?

- Present historical accounts in terms of individuals or social, ethnic, political, economic, or geographic groupings.
- Teach and conduct research in colleges, universities, museums, and other research agencies and schools.
- Interview people to gather information about historical events and to record oral histories.
- Organize information for publication and for other means of dissemination, such as use in CD-ROMs or Internet sites.
- Trace historical development in a particular field, such as social, cultural, political, or diplomatic history.
- Conduct historical research, and publish or present findings and theories.
- Research and prepare manuscripts in support of public programming and the development of exhibits at historic sites, museums, libraries, and archives.
- Conserve and preserve manuscripts, records, and other artifacts.
- Collect detailed information on individuals for use in biographies.
- Organize data, and analyze and interpret its authenticity and relative significance.

UK average: £32,296

Routes in: A large majority of historians combine teaching, writing and research at colleges and universities. You can also work as consultant in various domains.

Solicitor

What would I do?

- Providing legal services like conveyancing, probate, civil and family law, litigation, personal injury and criminal law
- Advising businesses and corporate clients in areas like contract law, tax, employment law and company sales and mergers
- Advising on insurance, patents, shipping, banking, the media or entertainment
- Providing advice in areas like education, planning and social services
- Advising government ministers
- Prosecuting people who break rules
- Advising and representing clients in court
- instructing barristers or advocates to act for clients
- Drafting confidential letters and contracts
- researching legal records and case law
- Attending meetings and negotiations
- Managing finances and preparing papers for court
- Using plain English to explaining complex legal matters to clients
- Keeping up to date with changes in the law

UK average: £43,194

Routes in: Bachelor degree in Law.

Archivist

What would I do?

- Storing materials correctly and keeping them in good condition
- Identifying, dating, cataloguing and indexing archive materials
- Helping people use the archives
- Making records available to users in formats such as photocopies, microfiche and online
- Carrying out research
- Giving talks and organising presentations, displays and exhibitions
- Negotiating the buying or donation of archive material

UK average: £26,433

Routes in: With experience, you could work with larger and more prestigious organisations, like national archives and museums, businesses, church foundations and charities.



Psychology

In Psychology, we at President Kennedy School are committed to supporting you develop a deeper understanding of yourselves and others through the exploration of psychological theories, concepts and studies. Teaching will be led by high quality subject specialists. You will be introduced to a variety of explanations for human behaviour and you will develop a number of skills that will support you in applying for higher education opportunities.

Entry Requirements

5 GCSEs at grade 5 or above, including English and Maths

Topics covered

Social Influence	Research Methods
Memory	Issues and Debates
Attachment	Relationships
Psychopathology	Schizophrenia
Approaches in Psychology	Forensic Psychology
Biopsychology	

Skills you will develop on the course

Whilst increasing your knowledge of psychological theories, concepts and studies, you will also develop the following skills:

- Application of knowledge to contemporary examples
- Analysis of research findings
- Synthesis of cross-curricular concepts
- Evaluation of theories and studies, including methods

Assessment

There are three external exams sat in May/June at the end of your final year (13).

Paper 1: Introductory topics in Psychology (Social Influence, Memory, Attachment, Psychopathology), 2 hours, 33%
Paper 2: Psychology in Context (Approaches in Psychology, Biopsychology and Research Methods), 2 hours, 33%
Paper 3: Issues and Options in Psychology (Issues and Debates, Relationships, Schizophrenia, Forensic Psychology), 2 hours, 33%

Educational trips, visits and wider experiences

To further enhance students' psychological knowledge and appreciation of the subject, student will visit and attend psychology masterclasses in some of the world's leading universities for psychology. Students will also experience talks from leading psychologists to help further widen their career ambitions.

What type of students will do well on this course?

You will need to be passionate about understanding others, have excellent time management, be prepared to develop your independent learning skills, enjoy discussions and debates and be able to write scientifically.

For more information contact:

Mr Dang - Leader of Psychology & Teacher of Law
DANGB@pks.coventry.sch.uk

Post-School Progression Opportunities

University	Entry requirements	Other similar courses offered
UCL (University College London) Psychology BSc (Hons)	A*, A, A to include at least one, preferably two subjects from Biology, Chemistry, Mathematics, Physics and Psychology.	Psychology and Language Sciences BSc (Hons) (lower entry requirements) Psychology with Education BSc (Hons) (lower entry requirements)
Royal Holloway, University of London Psychology BSc (Hons)	A, A, A – A, A, B (EPQ will lower offer)	Applied Psychology BSc (Hons) Criminology and Psychology BSc (Hons) Psychology, Clinical Psychology and Mental Health BSc (Hons) Psychology, Clinical and Cognitive Neuroscience BSc (Hons) Psychology, Development and Developmental Disorders BSc (Hons) Criminology and Psychology with a Year in Industry BSc (Hons) (4 years full time)
Bath Spa University Psychology BSc (Hons)	B, C, C – C, C, C	Business Psychology BSc (Hons) Psychology and Sociology BSc (Hons)

Career Opportunities

Clinical Psychologist

What would I do?

- A Clinical Psychologist deals with a wide range of mental and psychological health problems including depression, addiction, anxiety, difficulty learning and relationship issues. They use psychological therapies and procedures to help patients overcome these problems.
- Clinical Psychologists often work in a variety of settings including schools, prisons, research institutions and universities and in private practice. They can meet with clients in different locations to identify the problems in their lives. Their top methods of diagnosing psychological problems are through observations, interviews and tests.

Salary: Starting: £32,306

UK average: £47,395 per year

Routes in: Bachelor's degree accredited by the British Psychological Society and at least three years postgraduate study. Can be sponsored and trained by the NHS

Sport and Exercise Psychologist

What would I do?

- Assess your clients' needs and abilities, and monitor sporting performance and behaviour
- Implement strategies to help clients overcome difficulties, improve performance or realise potential
- Work with a multidisciplinary team including other psychologists, nutritionists, GPs, coaches and physiologists
- Deliver counselling and/or workshops covering issues such as goal setting, visualisation and relaxation
- Conduct and apply research in sport or exercise psychology

Salary: Starting: £20,000 - £22,000

UK average: £27,000 - £48,000

Routes in: Bachelor's degree accredited by the British Psychological Society (BPS), a BPS accredited MSc in Sport and Exercise Psychology, two years of supervised practice

Social Worker

What would I do?

- Conduct interviews with individuals and families to assess and review their situation
- Undertake and write up assessments (sometimes in collaboration with other professionals), which meet specified standards and timescales
- Offer information and support
- Organise and manage packages of support to enable people to lead the fullest lives possible
- Recommend and sometimes make decisions about the best course of action for a particular person or family
- Liaise with, and making referrals to, other agencies
- Participate in multidisciplinary teams and meetings regarding, for example, child protection or mental health
- Maintain accurate records and prepare reports for legal action
- Give evidence in court
- Participate in training, supervision and team meetings.

Salary: Starting: £24,000

UK average: £30,000 - £40,000

Routes in: Bachelor's Degree (2:2 or 2:1 minimum grade) and a Postgraduate Degree in Social Work.



President
Kennedy
School
Building Brighter Futures



Sociology

The Sociology department at President Kennedy School is committed to helping shape young minds develop a sociological imagination. Students will develop a critical understanding of the world they live in which is required to achieve academic success in this subject. The faculty consists of experienced subject specialists who have been trained by leading examiners of the subject. Additionally, this subject will enable students to develop insightful arguments both written and verbally which are highly valued by universities and employers.

Entry Requirements

A minimum of grade 5 or above in English, Maths and Science and in GCSE Sociology if taken.

Topics covered

- Education with Research Methods
- Families and Households
- Beliefs in Society
- Crime and Deviance
- Theory and Methods

Skills you will develop on the course

- Analytical skills
- Evaluation skills
- Communication and debating skills
- Critical thinking skills

Assessment

- 3 exams
- Paper 1: Education with Research Methods (2 hours)
- Paper 2: Families and Households and Beliefs in society (2 hours)
- Paper 3: Crime and Deviance with Theory and Methods (2 hours)

Educational trips, visits and wider experiences

Other than great teaching, what else is on offer? Students will have a culturally rich experience exploring an art exhibition which tracks how the notion of childhood has transformed over the past 100 years. Furthermore, students will have a taste of the criminal justice system, uncovering the truths behind law and order. Finally students will have the opportunity to be lectured by one of the world leading universities in Sociology.

What type of students will do well on this course?

We are looking for hard working and passionate students who feel strongly about inequality and social issues. Sociology is a fantastic subject for those who wish to explore and critique society and to share arguments and opinions. This subject complements other social science subjects, including English and Geography.

For more information contact:

Mr Taylor - Leader of Sociology
taylord@pks.coventry.sch.uk

Post-School Progression Opportunities

University	Entry requirements	Other similar courses offered
University of Warwick Sociology BA	ABB with a minimum Grade 4 in English and Maths.	Politics and Sociology (BA) History and Sociology (BA) Law and Sociology (BA)
Birmingham City University Sociology - BA (HONS)	BBC or 112 UCAS tariff points from a maximum of 3 subjects.	Sociology and Criminology BA (HONS) Psychology with Sociology BSC (HONS)
London School of Economics BSc Sociology	A strong set of GCSE grades including some at A (or 7) and A* (or 8-9) GCSE English Language and Mathematics no lower than B (or 6)	BA Social Anthropology BSc Language, Culture and Society BSc International Social and Public Policy

Career Opportunities

Counsellor

What would I do?

- Building a relationship of trust and respect
- Agreeing what will be covered in sessions
- Helping clients to talk about their concerns
- Listening carefully, asking questions and checking your understanding
- Empathising but challenging when necessary
- Helping clients to see things more clearly or differently
- Undergoing therapy yourself (needed for accreditation) and meeting your supervisor
- Keeping confidential records

UK average: £25,970

Routes in: You may be able to move into management, administration, supervision or training.

Political Scientist

What would I do?

- Interpret and analyze policies, public issues, legislation, or the operations of governments, businesses, and organizations.
- Maintain current knowledge of government policy decisions.
- Evaluate programs and policies, and make related recommendations to institutions and organizations.
- Develop and test theories, using information from interviews, newspapers, periodicals, case law, historical papers, polls, or statistical sources.
- Collect, analyze, and interpret data such as election results and public opinion surveys, reporting on findings, recommendations, and conclusions.
- Write drafts of legislative proposals, and prepare speeches, correspondence, and policy papers for governmental use.
- Forecast political, economic, and social trends.
- Consult with and advise government officials, civic bodies, research agencies, the media, political parties, and others concerned with political issues.
- Disseminate research results through academic publications, written reports, or public presentations.

UK average: £32,296

Routes in: Higher education institutions.

Forensic Psychologist

What would I do?

- Preparing specialist risk assessments for offenders
- Advising on the best location for prisoners
- Developing treatment and rehabilitation programmes
- Providing psychological therapy
- Offering expert advice to parole boards, mental health review tribunals or court cases
- Producing formal written reports
- Helping to write policies and strategies
- Training and mentoring new and trainee psychologists
- Finding ways to reduce stress and improve life inside prisons

UK average: £42,937

Routes in: You could go on to run a prison psychology department, move into a policy and strategy-based role or a management post focusing on specific issues.



Spanish

At President Kennedy School, the Spanish A-Level curriculum aims to foster pupils' curiosity and deepen their understanding of the world through teaching culture and language. Our teaching enables pupils to express and debate their ideas and thoughts and to understand and respond to native speakers, both in speech and in writing. It also provides opportunities for students to communicate for practical purposes, learn new ways of thinking, read literature and analyse film in Spanish. Strong teaching enables our students to be prepared for future study and employment.

Entry Requirements

Students will be expected to achieve a grade 6 in Spanish at GCSE.

Topics covered

- Theme 1: Aspects of Hispanic society
 - Theme 2: Multiculturalism in Hispanic society
 - Theme 3: Artistic culture in the Hispanic world
 - Theme 4: Aspects of political life in the Hispanic world
-
- Literature and film study
 - La Casa de Bernarda Alba
 - El Laberinto del Fauno

Skills you will develop on the course

The A-Level specification builds on the knowledge, understanding and skills gained at GCSE. It constitutes an integrated study with a focus on language, culture and society. It fosters a range of transferable skills including communication, critical thinking, research skills and creativity, which are valuable to the individual and society. The content is suitable for students who wish to progress to employment or to further study, including a Modern Languages degree.

Assessment

A-Level Spanish is a linear course with all assessments taking place at the end of year 13.

- Paper 1: Listening, reading and writing
- Paper 2: Writing (essays on the film and literature studied)
- Paper 3: Speaking

To develop the skills required for the A Level, students will complete end of unit assessments throughout the course.

Educational trips, visits and wider experiences

Throughout the two-year course, we will watch 'La Casa de Bernarda Alba' live in the theatre. Students will have the opportunity to visit a local university to develop an understanding of the study of languages at university, take part in debating and business challenges run by Business Language Champions and complete work experience with the local translation agency Comtec.

What type of students will do well on this course?

Students with a passion for languages, a keen interest in developing their understanding of different cultures, critical thinkers and strong communicators do well in this subject.

For more information contact:

Mrs Twyman - Leader of MFL
twyman@pks.coventry.sch.uk

Post-School Progression Opportunities

University	Entry requirements	Other similar courses offered
University of Warwick Hispanic Studies BA (hons) with year abroad	ABB, including a grade A in Spanish	English and Hispanic Studies Hispanic Studies and Economics Hispanic Studies and Global Sustainable Development Hispanic Studies and History Hispanic Studies and Linguistics Politics, International Studies and Hispanic Studies Modern languages (to include the study of 2 or more languages – Mandarin, Italian, French, Russian...)
Coventry University Languages for Global Communication BA (hons) with year abroad	BBC, including a grade B in Spanish	English Language Teaching and Applied Linguistics MA English and Creative Writing BA English Language and Teaching English as a Foreign Language BA(Hons)
University of Birmingham Modern Languages (hons) with year abroad	ABB, including a grade A in Spanish	Modern Languages with Business Management Spanish Studies and International Relations Modern Languages with History Modern Languages with English Modern Languages with History of Art Modern Languages with Music English as a Modern Foreign Language
Durham University Modern Languages and Cultures BA (hons) with year abroad	AAA, including a grade A in Spanish	Modern Languages and History BA Liberal Arts BA

Career Opportunities

Secondary school teacher

What would I do?

- Planning and preparing lessons
- Teaching your specialist subject
- Creating a safe learning environment
- Setting and marking essays and exams
- Checking students' progress
- Developing new courses and teaching materials
- Classroom administration and record keeping
- Attending meetings and training courses

Salary: Starting: £25,714

UK average: £40,881

Routes in: Bachelor's degree

Economist

What would I do?

- Researching information from computer databases, websites, journals and newspapers
- Monitoring past and present economic issues and trends
- Creating mathematical models to predict future economic developments
- Analysing statistics
- Writing reports and presenting findings
- Examining the effectiveness of current policies
- Advising on the potential economic impact of policies and ideas

UK average: £45,392

Routes in: Bachelor's degree

Broadcast journalist

What would I do?

- Following story 'leads', or generating story ideas
- Researching stories, using the internet, archives and databases
- Writing scripts, and website or social media content
- Preparing and conducting live and pre-recorded interviews
- Presenting in TV or radio studios or on location, and recording voiceovers for recorded material
- Asking questions at briefings and press conferences
- Directing a small camera or sound crew, or operating recording equipment yourself

UK average: £40,396

Routes in: Bachelor's degree



STOKE PARK
— SCHOOL —

BTEC Level 3 National Diploma in Sport

At Barr's Hill School we are committed to ensuring students receive top quality teaching and learning experiences. Students will be taught by experienced members of staff and will complete both internal and external units as part of the course. Alongside the course they will have character building opportunities to support them with their future aspirations.

BTEC Level 3 National Diploma in Sport

During this course you will study both external components (exam), and internal components (coursework). You will undertake mandatory units, and some optional units which will be based around practical activity. Support and guidance will be provided throughout the course and historically the average grade that student achieve on this course is D*D.

Coaching qualifications

A level 1/2 coaching qualification is the first stepping-stone on the coaching pathway. It will provide you with an introduction to coaching a certain sport, and working with players of all ages. Having a level 1 coaching qualification in 2 sports will support your university application and is a fantastic qualification to add to your CV. It shows that you have good communication skills, are keen to develop your sporting knowledge, and have experience working well with others.

Quality coaching at Barr's Hill

At Barr's Hill we have a vast number of enrichment opportunities and provide access to sport on 3 levels -

1. To ensure all young people are physically active,
2. To develop school teams,
3. To develop elite players and help them to develop through providing links to external clubs. We have strong links with external agencies in Football, Basketball, Trampolining and Dance all on our doorstep! Students who study this course can take advantage of these links and train and coach with sporting specialists at a variety of levels.

Employment Opportunities

Once students have achieved their coaching badges there is a possibility of them being employed to run lunch and after school academies in their chosen sport. Students can be employed as coaches to help work with our school teams and put their coaching skills into practice.

Nike Tracksuit

Students will be able to purchase a full Nike tracksuit and Nike t-shirts at a discounted price. Due to the practical nature of the course they will be able to wear this during the days that they will be studying Sport.

Sports tours

During the Easter holidays students can opt to attend a sporting tour where they will either travel abroad or stay in the UK and experience high quality coaching in a sport of their choice. They will play fixtures against other teams and have the opportunity to attend excursions that may be of interest to them. This action pack tour also builds in revision opportunities in preparation for the external assessments that students will take in summer.

Careers

Sports Therapist

What would I do?

- Seeing patients who have injured themselves through sport and assessing the injury
- Treating injuries through massage, mobilisations and electrotherapy and applying strapping
- Developing a programme for patients that is designed to restore the normal range of movement and function
- Helping team players prepare for a game and testing a player's fitness
- Offering first aid during a game if anyone is injured

Starting: £16,333
UK average: £25,758

Routes in: Bachelor's degree

Physical Education Teacher

What would I do?

- Planning lessons
- Marking students' work
- Meeting with parents and carers to discuss pupils' progress
- Organising outings and sporting events
- Attending meetings and training events

Salary: Starting: £22,917
UK average: £33,824

Routes in: Bachelor's degree

Sport and Exercise Scientist

What would I do?

- Working with sports coaches and sports therapists to assess individuals and teams and improve their performance
- Working alongside doctors to help improve a client's health through physical activity
- Working with hospitals and Primary Care Trusts to help improve a client's health
- Running clinics and services in local leisure centres
- Taking part in research projects

Salary: Starting: £17,199
UK average: £53,750

Routes in: Bachelor's degree

Health Psychologist

What would I do?

- Addressing behaviour that damages health, such as smoking, over-eating and alcohol or drug abuse
- Encouraging people to look after their health and promoting healthy behaviour such as teeth cleaning and exercise
- Using psychological techniques to aid recovery
- Helping to improve communication between doctors, nurses and patients
- Studying the psychological effects of illness on patients and their families or carers

Salary: Starting: £18,972
UK average: £41,923

Routes in: Bachelor's degree

Company Director (Sport)

What would I do?

- Deciding on the direction the company should be heading in
- Monitoring the company's progress
- Appointing senior managers
- Making sure that the company is financially sound
- Being accountable to shareholders for the company's performance

Salary: Starting: £23,000
UK average: £70,000

Routes in: Bachelor's degree

Personal Trainer

What would I do?

- Educate and motivate clients to help them follow their programmes
- Advise clients on achieving a healthy lifestyle
- Work with clients in the gym, supervising workouts and exercises
- Monitor and record progress
- Educate and motivate clients to help them follow their programmes

Salary: Starting: £18,500
UK average: £30,000
Routes in: Bachelor's degree

University

University	Entry requirements	Other similar courses offered
Loughborough University Sport and Exercise Sciences BSc (Hons)	BTEC Level 3 National Diploma: D*D* including Distinctions in all units in combination with a grade A in a preferred A-level subject.	Sport Management BSc (Hons) Sport and Exercise Psychology BSc (Hons) Sport, Coaching and Physical Education BSc (Hons)
Durham University Sport and Exercise Sciences BSc (Hons)	BTEC Diploma in Sport at DD and a further BTEC at grade D	Sport, Exercise and Physical Activity BA (Hons)
University of Bath Health and Exercise Sciences BSc (Hons)	A in one A level subject plus DD in the BTEC National Diploma (RQF)	Sport Management and Coaching BSc (Hons) Sport and Exercise Science BSc (Hons) Sport Management and Coaching BSc (Hons)
University of Birmingham Sport, Exercise & Health Sciences BSc (Hons)	BTEC Diploma in Sport and Science related subjects accepted in combination with an A level (D*D* including Distinctions in all units plus grade A in an accepted subject). For Sport Diploma the A level must be in a core science subject.	Sport, PE and Coaching Science BSc (Hons) Physiotherapy BSc (Hons)
Coventry University Sport, Exercise & Health Sciences BSc (Hons)	BTEC Diploma in Sport at DM and a further BTEC at grade M in a Science based subject	Sport and exercise therapy BSc (Hons) Sport and exercise psychology BSc (Hons) Sport Management BA (Hons)
Cardiff Metropolitan University Sport and Exercise Sciences BSc (Hons)	BTEC Diploma in Sport at DD and a further BTEC at grade M	Sport Coaching - BSc (Hons) Sport Management - BSc (Hons) Sport Media - BSc (Hons) Sport Studies - BSc (Hons) Sport, Physical Education & Health - BSc (Hons)

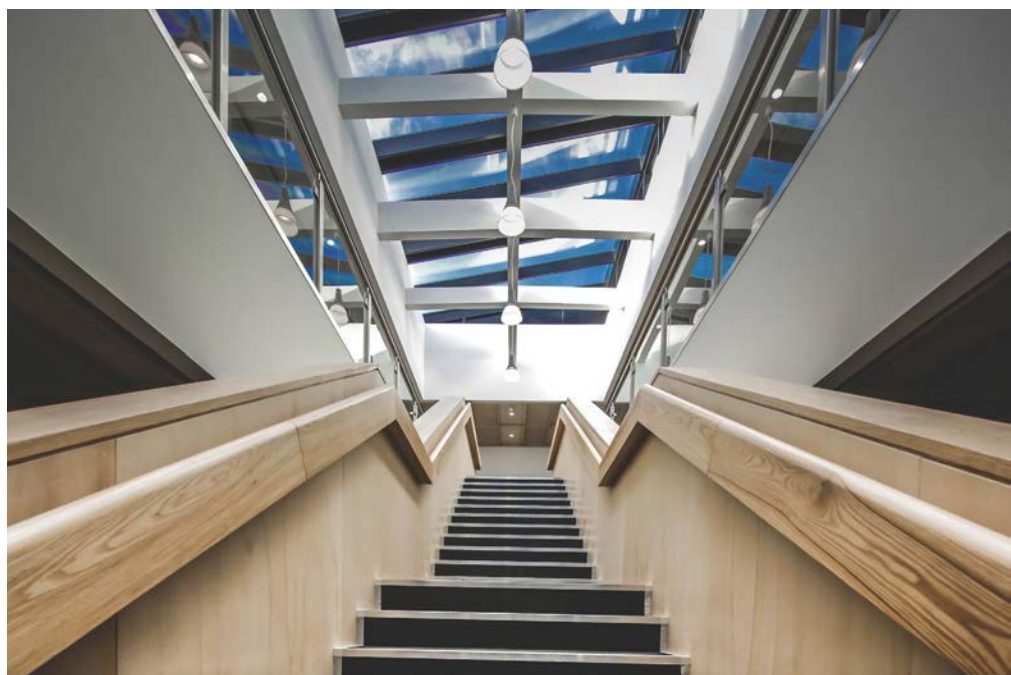

YOUR BRIGHTER FUTURE STARTS HERE...



President Kennedy School
Rookery Lane
Holbrooks
Coventry
CV6 4GL

T : 02476 661416
E : post16@pks.coventry.sch.uk

